

## Volantino 7 punte con Boccola Ottone Filettata Star Knob, 7 Points, Threaded Blind Insert

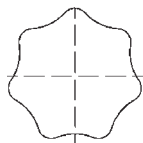
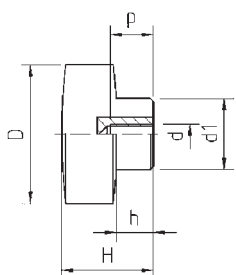

## V7B series

### Caratteristiche

#### Materiale Corpo:

Phenoplasto rinforzato di colore Nero, resistente a solventi, oli, grassi ed altri agenti chimici

#### Parte Metallica e/o

#### Fissaggio:

Boccola in ottone con foro cieco filettato

### Product specification

#### Main Part Material:

Black Phenoplast, solvents, oils, greases and other chemical agents proof

#### Metallic Part Material &

#### Finishing:

Brass Insert, Threaded Blind Hole

Codice	D	d	d1	H	h	P	Peso grammi Weight gr	Confezione Pz Packing Pcs.
B1V7B3004	30	04MA	17	23	10	8	15	20
B1V7B3005	30	05MA	17	23	10	10	15	20
B1V7B3006	30	06MA	17	23	10	12	16	20
B1V7B3008	30	08MA	17	23	10	16	17	20
B1V7B4006	40	06MA	21	27	11	12	30	20
B1V7B4008	40	08MA	21	27	11	16	33	20
B1V7B4010	40	10MA	21	27	11	16	33	20
B1V7B5006	50	06MA	25	35	15	12	57	20
B1V7B5008	50	08MA	25	35	15	16	59	20
B1V7B5010	50	10MA	25	35	15	22	61	20
B1V7B5012	50	12MA	25	35	15	22	68	20
B1V7B6008	60	08MA	28	39	18	16	85	20
B1V7B6010	60	10MA	28	39	18	22	88	20
B1V7B6012	60	12MA	28	39	18	22	93	20
B1V7B6014	60	14MA	28	39	18	22	98	20
B1V7B7010	70	10MA	30	42	18	22	121	20
B1V7B7012	70	12MA	30	42	18	22	127	20
B1V7B7014	70	14MA	30	42	18	22	133	20
B1V7B7016	70	16MA	30	42	18	22	138	20
B1V7B8012	80	12MA	32	53	28	22	186	20
B1V7B8014	80	14MA	32	53	28	22	186	20
B1V7B8016	80	16MA	32	53	28	22	187	20

## V7BP series

### Caratteristiche

#### Materiale Corpo:

Phenoplasto rinforzato di colore Nero, resistente a solventi, oli, grassi ed altri agenti chimici

#### Parte Metallica e/o

##### Fissaggio:

Boccola in ottone con foro passante filettato

### Product specification

#### Main Part Material:

Black Phenoplast, solvents, oils, greases and other chemical agents proof

#### Metallic Part Material &

##### Finishing:

Brass Insert, Threaded Thru-Hole

## Volantino 7 punte con Boccola Ottone Filettata Passante Star Knob, 7 Points, Threaded Thru-Insert

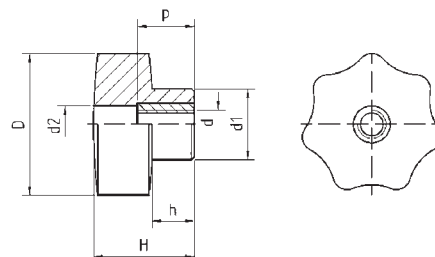

Codice	D	d	d1	d2	H	h	P	Peso grammi Weight gr	Confezione Pz Packing Pcs.
B1V7BP3004	30	04MA	17	10	23	10	15	13	20
B1V7BP3005	30	05MA	17	10	23	10	15	14	20
B1V7BP3006	30	06MA	17	10	23	10	15	15	20
B1V7BP3008	30	08MA	17	10	23	10	15	16	20
B1V7BP4006	40	06MA	21	10,5	27	11	20	35	20
B1V7BP4008	40	08MA	21	10,5	27	11	20	31	20
B1V7BP4010	40	10MA	21	10,5	27	11	20	32	20
B1V7BP5008	50	08MA	25	12,5	35	15	20	57	20
B1V7BP5010	50	10MA	25	12,5	35	15	20	58	20
B1V7BP5012	50	12MA	25	12,5	35	15	20	61	20
B1V7BP6008	60	08MA	28	14	39	18	20	73	20
B1V7BP6010	60	10MA	28	14	39	18	20	82	20
B1V7BP6012	60	12MA	28	14	39	18	20	85	20
B1V7BP7010	70	10MA	30	19	42	18	26	113	20
B1V7BP7012	70	12MA	30	19	42	18	26	116	20
B1V7BP7014	70	14MA	30	19	42	18	26	121	20
B1V7BP7016	70	16MA	30	19	42	18	26	115	20
B1V7BP8012	80	12MA	32	17	53	28	26	170	20
B1V7BP8016	80	16MA	32	17	53	28	26	167	20

## V7L series

### Caratteristiche

#### Materiale Corpo:

Phenoplasto rinforzato di colore Nero, resistente a solventi, oli, grassi ed altri agenti chimici

#### Parte Metallica e/o

##### Fissaggio:

Boccola in ottone con foro cieco liscio

### Product specification

#### Main Part Material:

Black Phenoplast, solvents, oils, greases and other chemical agents proof

#### Metallic Part Material &

##### Finishing:

Brass Insert, NonThreaded Blind Hole

## Volantino 7 punte con Boccola in Ottone Liscia Star Knob, 7 Points, Non-Threaded Blind Insert

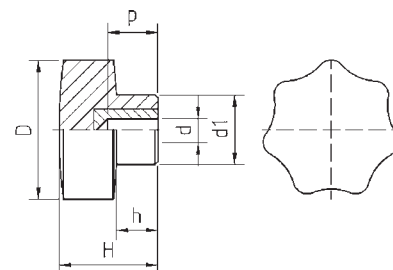

Codice	D	d	d1	H	h	P	Peso grammi Weight gr	Confezione Pz Packing Pcs.
B1V7L3006	30	6	17	23	10	12	8	20
B1V7L3008	30	8	17	23	10	16	9	20
B1V7L4008	40	8	21	27	11	16	37	20
B1V7L4010	40	10	21	27	11	18	37	20
B1V7L5008	50	8	25	35	15	16	66	20
B1V7L5010	50	10	25	35	15	22	73	20
B1V7L6010	60	10	28	39	18	24	103	20
B1V7L6012	60	12	28	39	18	24	103	20
B1V7L7012	70	12	30	42	18	24	142	20