

# Clamps for conical side guides



Nickel plated brass



303 Stainless steel



Reinforced polyamide



See pages 84 → 89



See pages 92 → 93



See page 171



Consult pages 134 → 137 for rod design



## SINGLE CLAMP

**Material:** clamp in reinforced polyamide, bolt in stainless steel, nut in nickel plated brass.

**Supply:** assembled.

**Packaging:** 50 pieces.

Code

13006NV

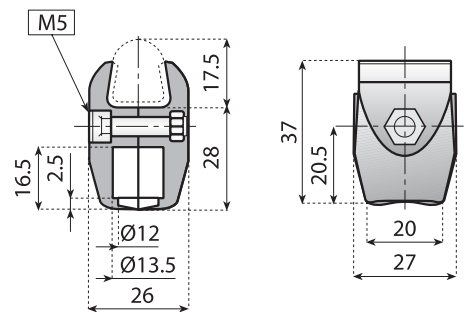

## SINGLE CLAMP WITH ROD

**Material:** clamp in reinforced polyamide, bolt in stainless steel, nut in nickel plated brass, rod in stainless steel AISI 303.

**Supply:** assembled.

**Packaging:** 50 pieces.

Code

13190

13191

DP

14

16

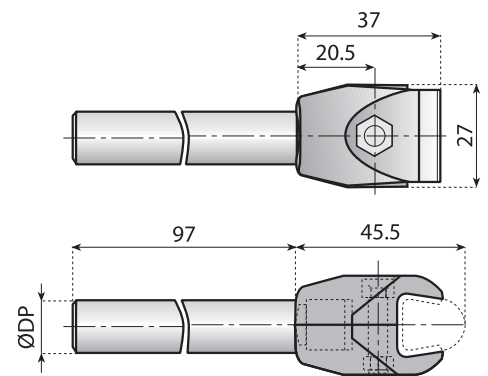

## SINGLE CLAMP

**Material:** clamp in reinforced polyamide, bolt in stainless steel, nut in nickel plated brass.

**Supply:** assembled.

**Packaging:** 50 pieces.

Code

13006

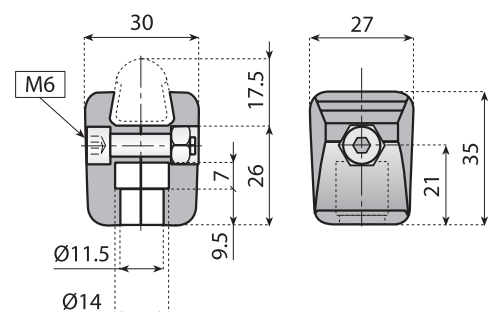

# Clamps for conical side guides



Nickel plated brass



303 Stainless steel



Reinforced polyamide



See pages 84 → 89



See pages 92 → 93



See page 171



Consult pages 134 → 137 for rod design



## SINGLE CLAMP WITH ROD

**Material:** clamp in reinforced polyamide, bolt in stainless steel, nut in nickel plated brass, rod in stainless steel AISI 303.

**Supply:** assembled.

**Packaging:** 50 pieces.

Code	DP
13192	12
13193	14
13194	16

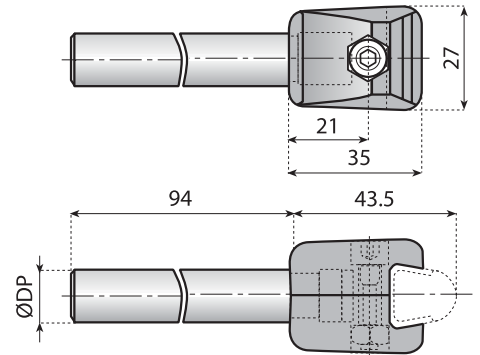

## SINGLE CLAMP

**Material:** clamp in reinforced polyamide, bolt in stainless steel, nut in nickel plated brass.

**Supply:** assembled.

**Packaging:** 50 pieces.

Code	DP
13788	16

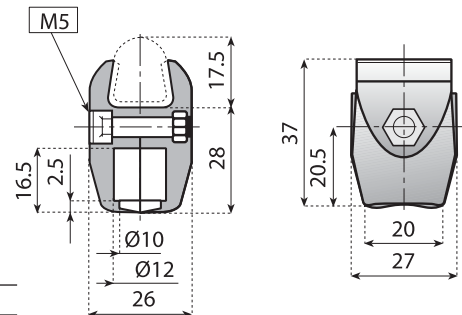

## SINGLE CLAMP WITH ROD

**Material:** clamp in reinforced polyamide, bolt in stainless steel, nut in nickel plated brass, rod in stainless steel AISI 303.

**Supply:** assembled.

**Packaging:** 50 pieces.

Code	DP
13789	12
13790	14
13791	16

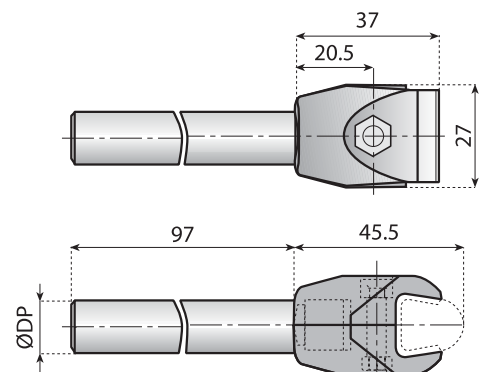

# Clamps for conical side guides



## SINGLE CLAMP WITH BOLT

**Material:** clamp in reinforced polyamide, bolt in stainless steel, nut in nickel plated brass.  
**Supply:** assembled.  
**Packaging:** 50 pieces.

**Code**  
**13792**

		
Nickel plated brass	303 Stainless steel	Reinforced polyamide
		
See pages 84 → 89	See pages 92 → 93	See page 171
		
		Consult pages 134 → 137 for rod design

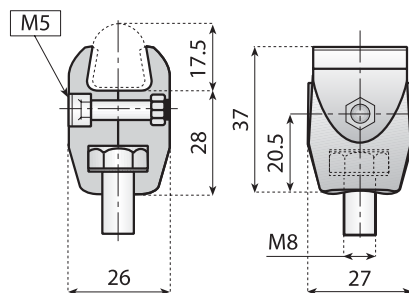

## SINGLE CLAMP WITH ROD

**Material:** clamp in reinforced polyamide, bolt in stainless steel, nut in nickel plated brass, rod in stainless steel AISI 303.  
**Supply:** assembled.  
**Packaging:** 50 pieces.

**Code**  
**13793**  
**13794**  
**13795**

DP  
 12  
 14  
 16

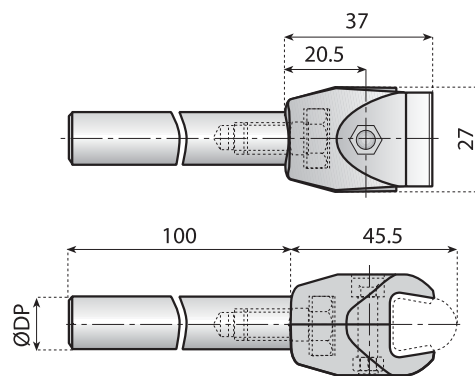

## ADJUSTABLE GUIDE RAIL CLAMP

**Material:** clamp in reinforced polyamide, bolts in stainless steel, nut in nickel plated brass.  
**Use:** mount on 25x6 flat bar or Ø 12 diameter rod.  
**Packaging:** 50 pieces.

**Code**  
**13195**

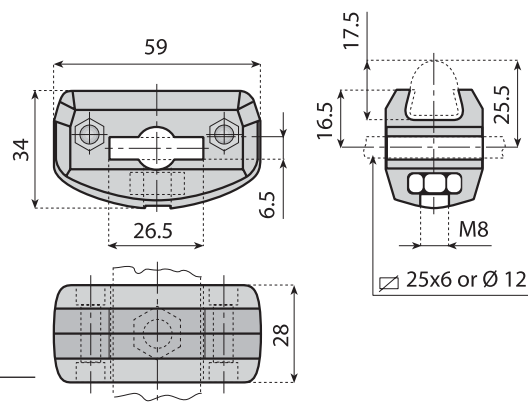

# Clamps for conical side guides



## ADJUSTABLE GUIDE RAIL CLAMP

**Material:** clamp in reinforced polyamide, bolts in stainless steel, nut in nickel plated brass.

**Supply:** assembled.

**Use:** mount on 25x8 flat bar.

**Packaging:** 50 pieces.

Code  
**13007**

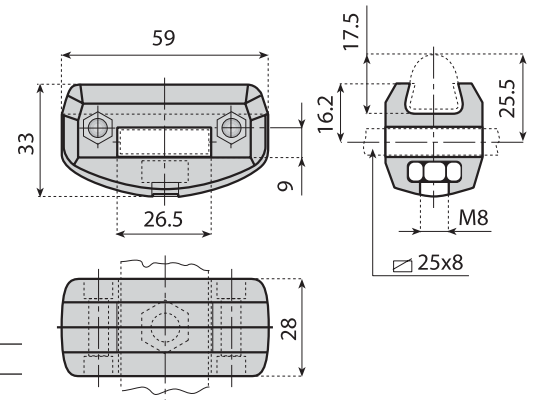

## ADJUSTABLE GUIDE RAIL CLAMP

**Material:** clamp in reinforced polyamide, bolts in stainless steel, nut in nickel plated brass.

**Supply:** assembled.

**Use:** mount on 25x8 flat bar.

**Packaging:** 50 pieces.

Code  
**13196**

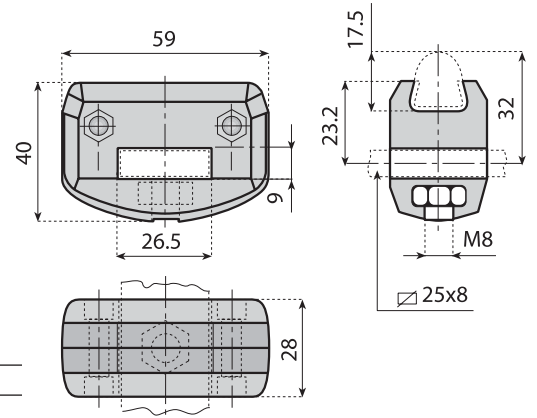

## ADJUSTABLE GUIDE RAIL CLAMP

**Material:** clamp in reinforced polyamide, bolts in stainless steel, nut in nickel plated brass.

**Supply:** assembled.

**Use:** mount on 25x10 flat bar.

**Packaging:** 50 pieces.

Code  
**13197**

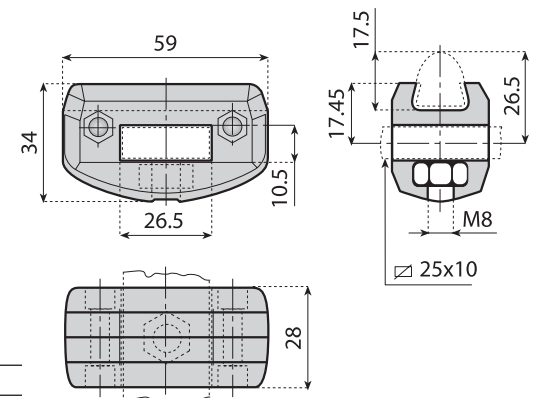

See pages 84 → 89	Nickel plated brass	303 Stainless steel	Reinforced polyamide
See pages 92 → 93	See page 171	Consult pages 134 → 137 for rod design	

# Clamps for conical side guides



Nickel plated brass



303 Stainless steel



Reinforced polyamide



See pages 84 → 89



See pages 92 → 93



See page 171



Consult pages 134 → 137 for rod design



## SINGLE CLAMP

**Material:** clamp in reinforced polyamide.

**Use:** it connects guide rail to bracket or rod using a standard M8 cap screw.

**Packaging:** 50 pieces.

Code

13012

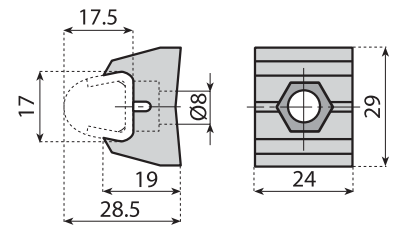

## SWIVEL CLAMP

**Material:** reinforced polyamide. nut, washer and rod in stainless steel.

**Supply:** assembled.

**Packaging:** 50 pieces.

**Note:** code 13167 is supplied without rod.

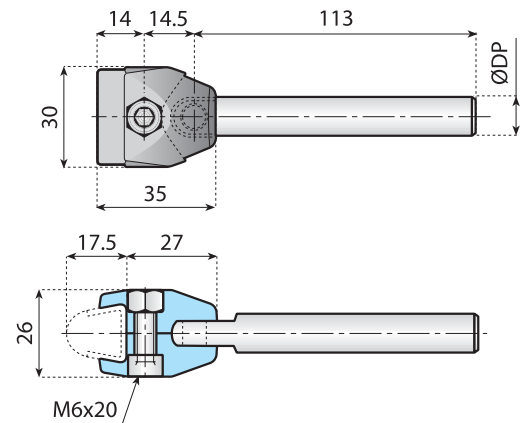

## APPLICATION EXAMPLE

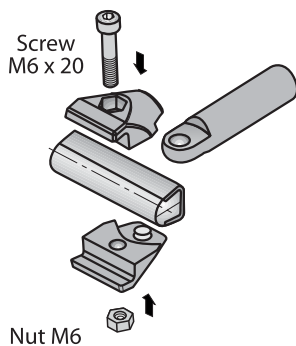

This design allows a max. swivel angle of 120°

Code

Code	DP
13167	-
13168	12
13169	14
13170	16

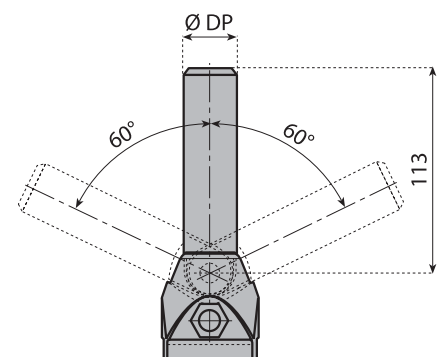

# Clamps for conical side guides



Nickel plated brass



303 Stainless steel



Reinforced polyamide



See pages 84 → 89



See pages 92 → 93



See page 171



Consult pages 134 → 137 for rod design

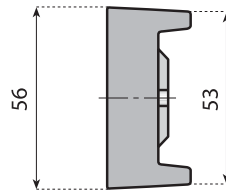
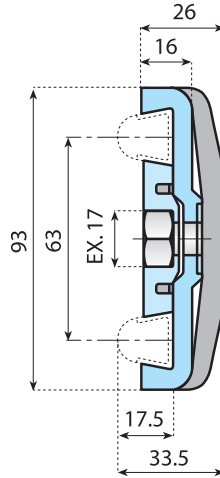

## DOUBLE CLAMP

**Material:** reinforced polyamide, nut, washer in stainless steel.

**Supply:** unassembled.

**Packaging:** 50 pieces.

Code

13008NV

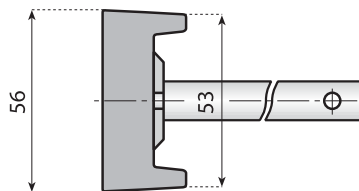
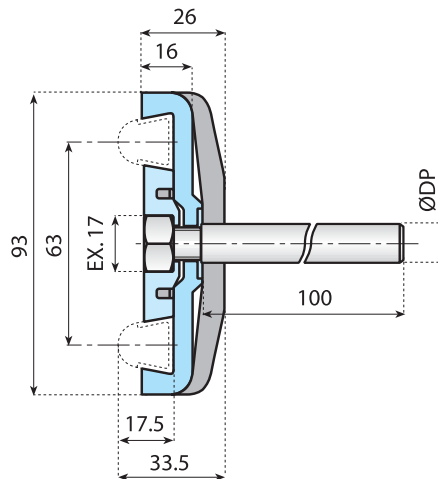

## DOUBLE CLAMP WITH ROD

**Material:** reinforced polyamide, washer rod in stainless steel.

**Supply:** assembled.

**Packaging:** 50 pieces.

Code

13009NV

13010NV

13011NV

DP

12

14

16

# Clamps for conical side guides and for round guide rails



See page 103



Nickel plated brass



303 Stainless steel



Reinforced polyamide



See pages 84 -> 89



See pages 92 -> 93



See pages 171



Consult pages 134 -> 137 for rod design

## DOUBLE CLAMP

**Material:** reinforced polyamide, nut, washer and rod in stainless steel.  
Codes 13175-13351-13163 are supplied without rod and nut.

**Application:** the clamp is designed to be used with either the conical or Ø 12 mm round guide rails, simply by turning the internal flange plate.

**Use:** to support rods or conical guide rails with increased centers.

**Supply:** assembled.

**Packaging:** 50 pieces.

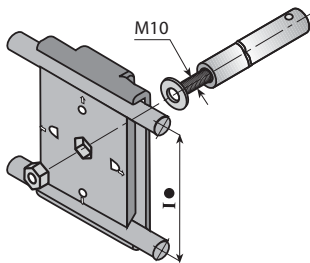

Flange position for assembling conical side guide

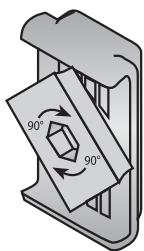
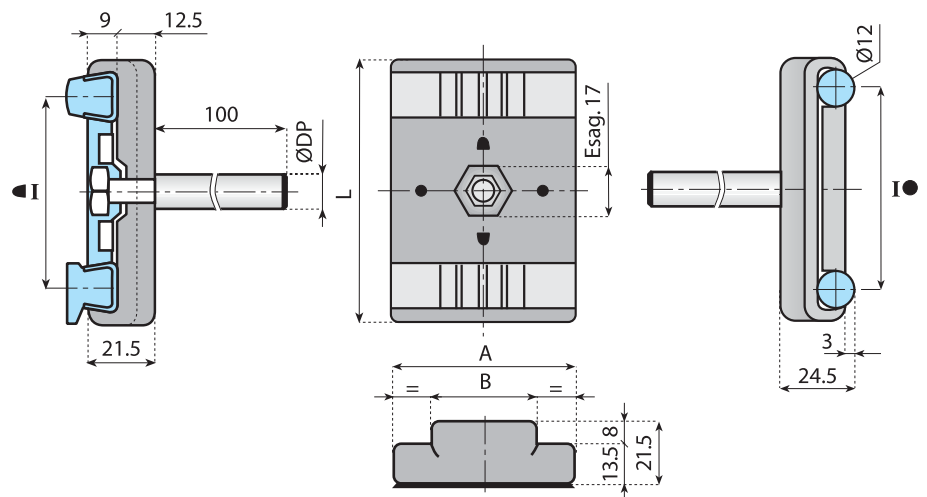

Rotate center piece 90°

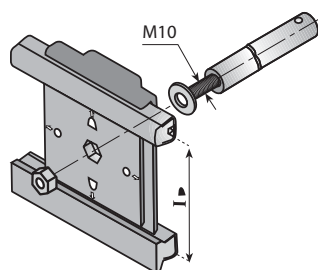

Flange position for assembling Ø 12 mm rod

Code	I ●	I ◀	L	A	B	Ø DP
13175	51	47	70	43	30	-
13176	51	47	70	43	30	12
13177	51	47	70	43	30	14
13178	51	47	70	43	30	16
13351	69	65	90	61	35	-
13352	69	65	90	61	35	12
13353	69	65	90	61	35	14
13354	69	65	90	61	35	16
13163	89	85	110	80	40	-
13164	89	85	110	80	40	12
13165	89	85	110	80	40	14
13166	89	85	110	80	40	16



# Clamps for conical side guides and for round guide rails



See page 103



Nickel plated brass



303 Stainless steel



Reinforced polyamide



See pages 84 → 89



See pages 92 → 93



See page 171



Consult pages 134 → 137 for rod design

## DOUBLE CLAMP

**Material:** reinforced polyamide, screw, washer and rod in stainless steel. Codes 13175F - 13351F - 13163F are supplied without rod and screw.

**Application:** the clamp is designed to be used with either the conical or Ø 12 mm round guide rails, simply by turning the internal flange plate.

**Use:** to support rods or conical guide rails with increased centers.

**Supply:** assembled.

**Packaging:** 50 pieces.

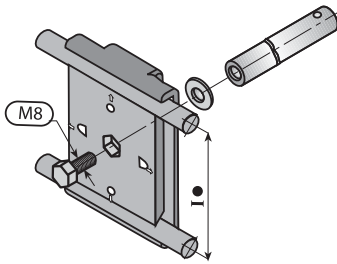

Flange position for assembling conical side guide

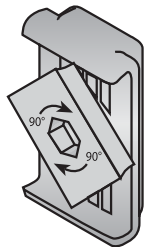

Rotate center piece 90°

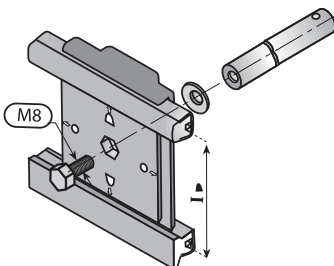

Flange position for assembling Ø 12 mm rod

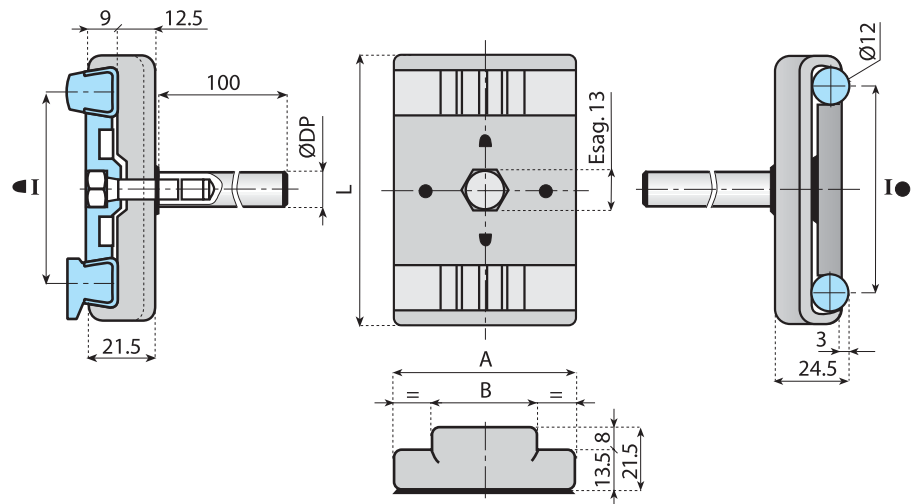

Code	I ●	I ▸	L	A	B	Ø DP
13175F	51	47	70	43	30	-
13176F	51	47	70	43	30	12
13177F	51	47	70	43	30	14
13178F	51	47	70	43	30	16
13351F	69	65	90	61	35	-
13352F	69	65	90	61	35	12
13353F	69	65	90	61	35	14
13354F	69	65	90	61	35	16
13163F	89	85	110	80	40	-
13164F	89	85	110	80	40	12
13165F	89	85	110	80	40	14
13166F	89	85	110	80	40	16



# Clamps for conical side guides



*New design*

## SINGLE RAIL CLAMP

**Material:** stainless steel AISI 304, thickness  $S = 2$  mm.

**Packaging:** 50 pieces.

**Use:** to support conical guide.

**Note:** round hole version accepts a M8 bolt and square hole version accepts a M8 carriage bolt.

Available in two lengths 38.1 mm wide and 76.2 mm wide for splicing. Tightening bolt not included.

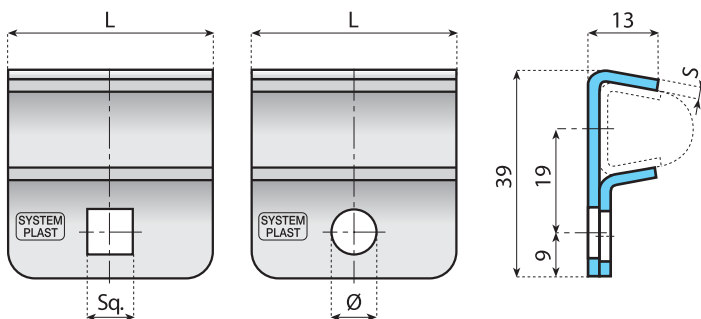

304 Stainless steel

For sufficient quantities parts can be produced in



Zinc plated steel

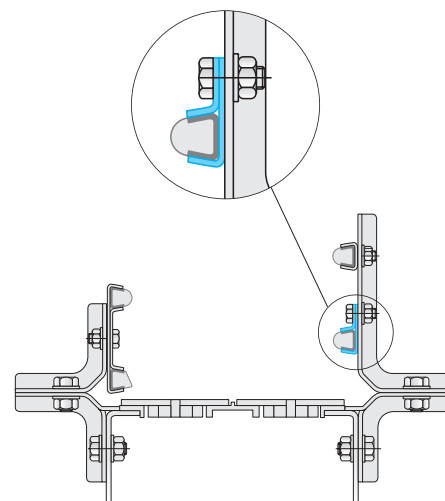

Code	L mm	Ø ● mm	Sq. ■ mm
13014	38.1	8.1	-
13014S	38.1	-	9
13014L	76.2	8.1	-
13014SL	76.2	-	9



304 Stainless steel

For sufficient quantities parts can be produced in



Zinc plated steel

*New range and design*

## SINGLE RAIL CLAMP WITH THREADED INSERT

**Material:** stainless steel AISI 304, thickness  $S = 2$  mm.

**Packaging:** 50 pieces.

**Use:** two piece compression style for easy assembly and adjustment. Nut and washer not included.

**Note:** max recommended tightening torque 2.0 Kgm.

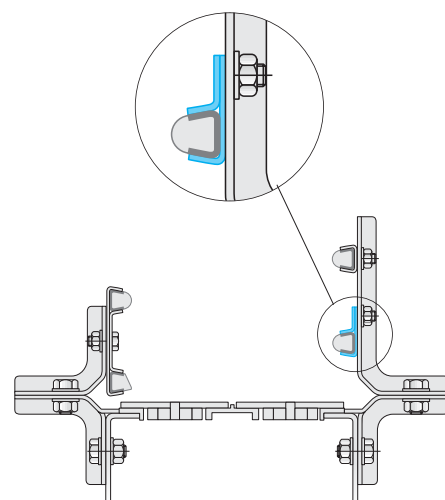
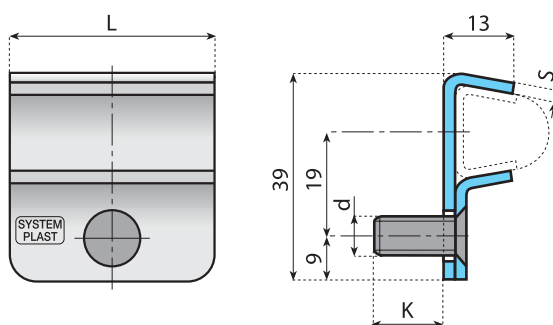

Code	L mm	K mm	d thread size
131016	38.1	16	M8
131017	38.1	21	M8
131018	38.1	26	M8
131019	38.1	31	M8

# Clamps for conical side guides



*New design*

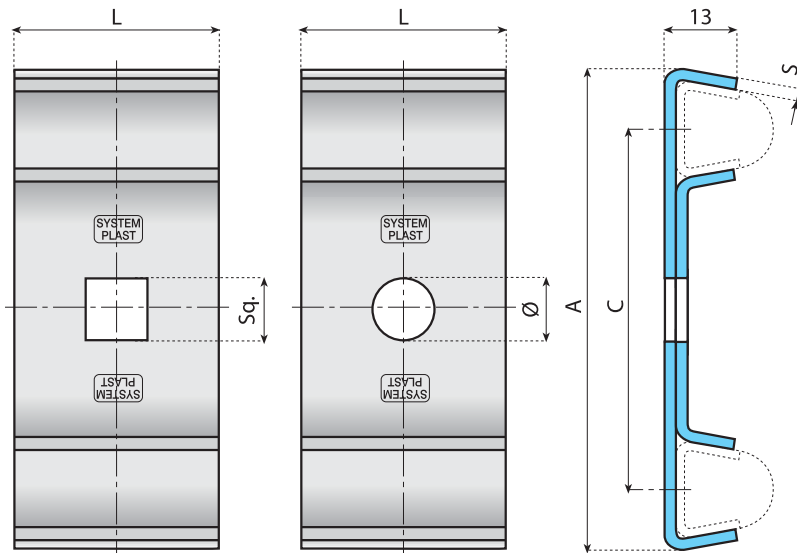

304 Stainless steel

For sufficient quantities parts can be produced in



Zinc plated steel

## DOUBLE RAIL CLAMP

**Material:** stainless steel AISI 304, thickness  $S = 2.5$  mm.

**Packaging:** 50 pieces.

**Use:** to support conical guide.

**Note:** round hole version accepts a M8 bolt and square hole version accepts a M8 carriage bolt.

Available in two lengths 38.1 mm wide and 76.2 mm wide for splicing. Tightening bolt not included.

Code	L mm	A mm	C mm	Ø ●	Sq. ■
13013	38.1	86	63.5	10.5	-
13013S	38.1	86	63.5	-	9
13013L	76.2	86	63.5	10.5	-
13013SL	76.2	86	63.5	-	9
131001	38.1	106.5	84	10.5	-
131001S	38.1	106.5	84	-	9
131001L	76.2	106.5	84	10.5	-
131001SL	76.2	106.5	84	-	9
131002	38.1	117.7	95.2	10.5	-
131002S	38.1	117.7	95.2	-	9
131002L	76.2	117.7	95.2	10.5	-
131002SL	76.2	117.7	95.2	-	9

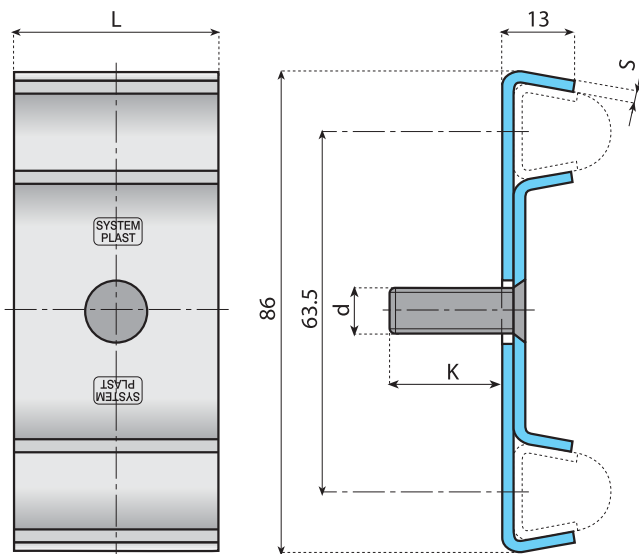
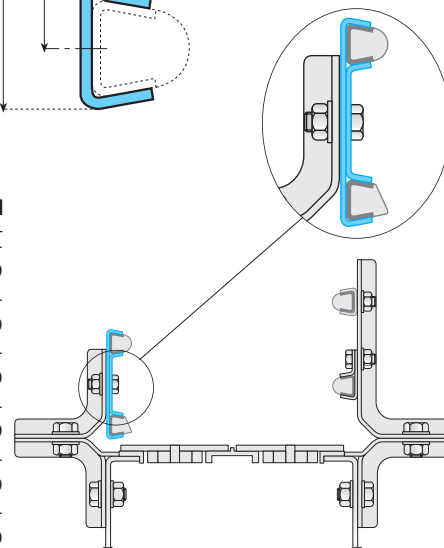

For sufficient quantities parts can be produced in



Zinc plated steel



304 Stainless steel

## DOUBLE RAIL CLAMP WITH THREADED INSERT

**Material:** stainless steel AISI 304, thickness  $S = 2.5$  mm.

**Packaging:** 50 pieces.

**Use:** two piece compression style for easy assembly and adjustment. Nut and washer not included.

**Note:** max recommended tightening torque 3.0 Kgm.

Code	L mm	K mm	d thread size
131020	38.1	16	M8
131021	38.1	21	M8
131022	38.1	26	M8
131023	38.1	31	M8

*New range and design*

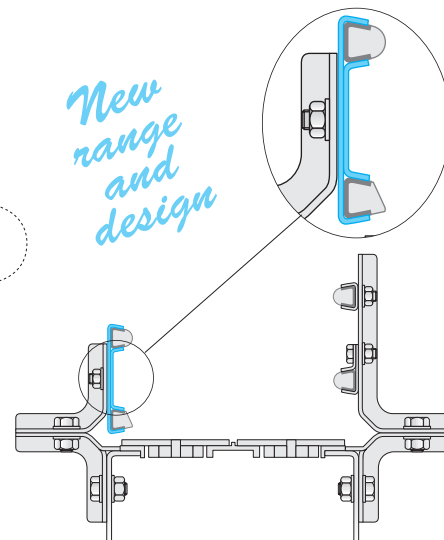

# Clamps for conical side guides

*New*

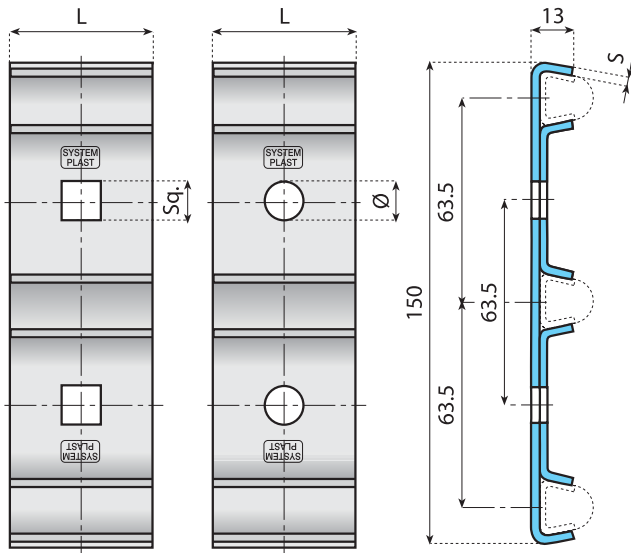

For sufficient quantities parts can be produced in



Zinc plated steel



304 Stainless steel

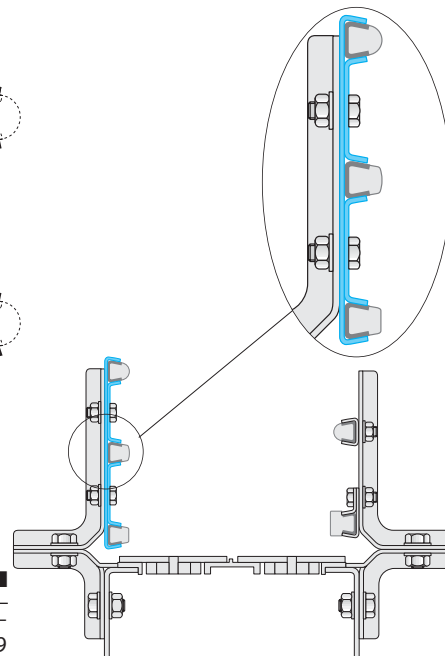

## TRIPLE RAIL CLAMP

**Material:** stainless steel AISI 304, thickness  $S = 2.5$  mm.

**Packaging:** 50 pieces.

**Note:** used with toll containers or when large and small containers run on the same production line. Tightening bolt not included.

Code	L mm	Ø ●	Sq. ■
131003	38.1	10.5	-
131003S	38.1	-	9

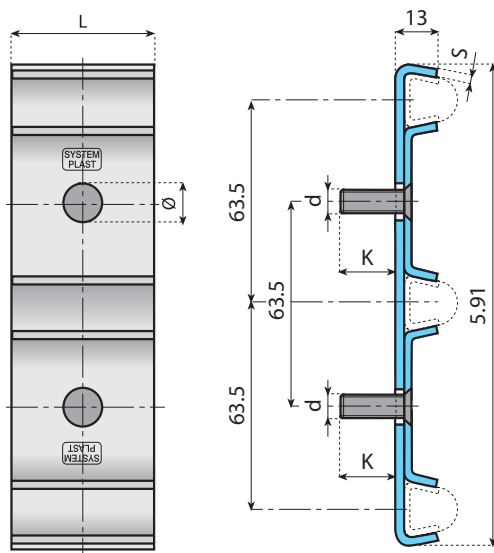

For sufficient quantities parts can be produced in



Zinc plated steel



304 Stainless steel

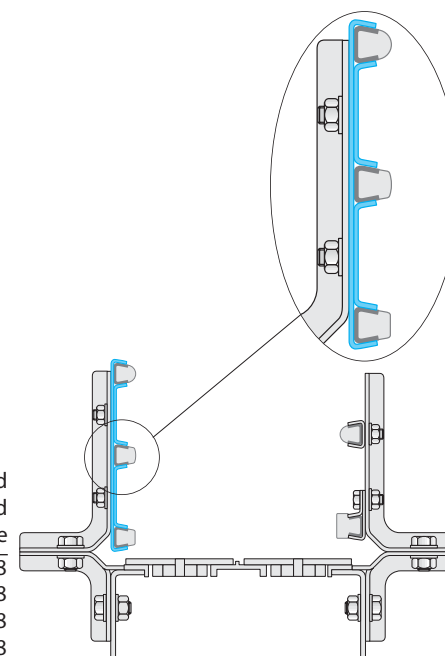

## TRIPLE RAIL CLAMP WITH THREADED INSERT

**Material:** stainless steel AISI 304, thickness  $S = 2.5$  mm.

**Packaging:** 50 pieces.

**Use:** two piece compression style for easy assembly and adjustment. Nut and washer not included.

**Note:** max recommended tightening torque 3.0 Kgm.

Code	L mm	K mm	d thread size
131024	38.1	16	M8
131025	38.1	21	M8
131026	38.1	26	M8
131027	38.1	31	M8

# Clamp for conical side guides

For sufficient quantities parts can be produced in



Zinc plated steel



304 Stainless steel

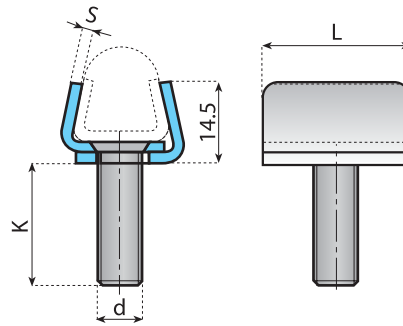

## HEAVY DUTY CLIP

**Material:** stainless steel AISI 304, thickness  $S = 2.5$  mm.

**Packaging:** 100 pieces.

**Use:** two piece compression style for easy assembly and adjustment. Nut and washer not included.

**Note:** max recommended tightening torque 2.0 Kgm.

Code	L mm	K mm	d thread size
131004	26	16	M8
131005	26	21	M8
131006	26	26	M8
131007	26	31	M8

For sufficient quantities parts can be produced in



Zinc plated steel



304 Stainless steel

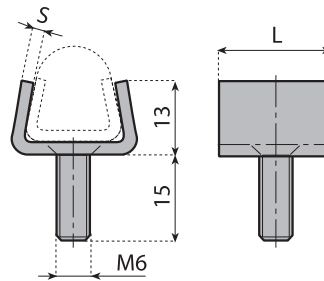

*Light duty*

## SINGLE CLAMP

**Material:** stainless steel AISI 304, thickness  $S = 2.5$  mm.

**Packaging:** 100 pieces.

**Use:** easy assembly of guide profiles.

**Note:** max recommended tightening torque 1.8 Kgm.

Code	L mm
13796	20

For sufficient quantities parts can be produced in



Zinc plated steel



304 Stainless steel

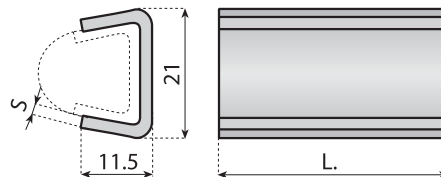

## CONNECTING ELEMENT

**Material:** stainless steel AISI 304, thickness  $S = 2.5$  mm.

**Packaging:** 50 pieces.

**Use:** to connect two guide rails. The part can be tapped on with a hammer.

Code	L mm
13015	38
13120	50

# Clamps for standard side guides



Nickel plated brass



303 Stainless steel



Reinforced polyamide



See page 95



Consult pages 134 → 137 for rod design

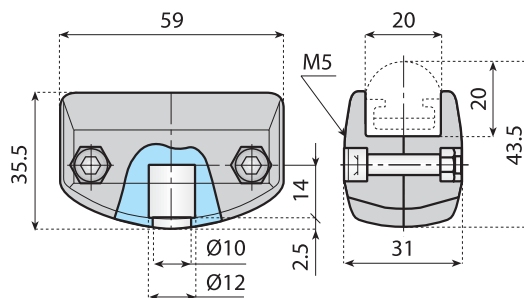

Code

13001

## SINGLE CLAMP

**Material:** clamp in reinforced polyamide, bolt in stainless steel, nut in nickel plated brass.

**Supply:** assembled.

**Packaging:** 100 pieces.

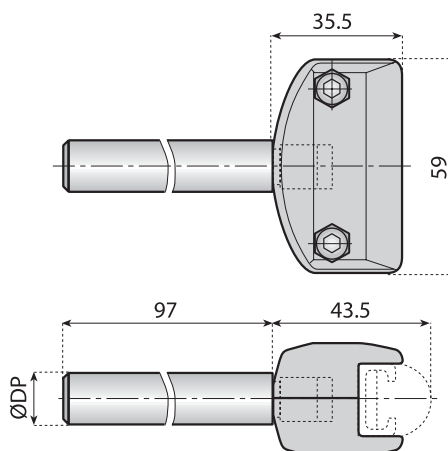

Code

13002

13003

13004

DP

12

14

16

## SINGLE CLAMP WITH ROD

**Material:** clamp in reinforced polyamide, bolt in stainless steel, nut in nickel plated brass, rod in stainless steel AISI 303.

**Supply:** unassembled.

**Packaging:** 50 pieces.

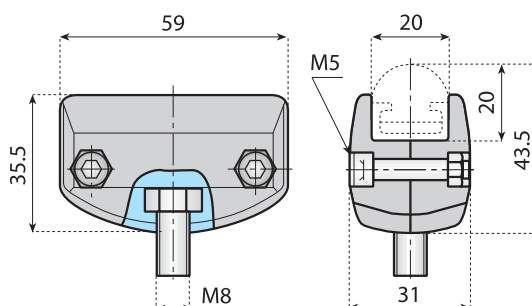

Code

13184

## SINGLE CLAMP

**Material:** clamp in reinforced polyamide, bolt in stainless steel, nut in nickel plated brass.

**Supply:** assembled.

**Packaging:** 100 pieces.

# Clamps for standard side guides



Nickel plated brass



303 Stainless steel



Reinforced polyamide



See page 95



Consult pages 134 → 137 for rod design



## SINGLE CLAMP WITH ROD

**Material:** clamp in reinforced polyamide, bolt in stainless steel, nut in nickel plated brass, rod in stainless steel AISI 303.

**Supply:** unassembled.

**Packaging:** 50 pieces.

Code	DP
13797	12
13798	14
13799	16

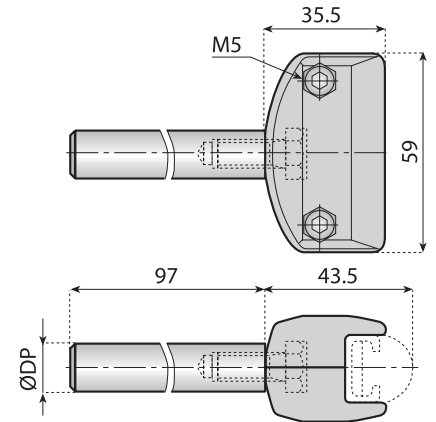

## ADJUSTABLE SINGLE CLAMP

**Material:** clamp in reinforced polyamide, bolt in stainless steel, nut in nickel plated brass.

**Supply:** assembled.

**Packaging:** 50 pieces.

Code	DP
13005	

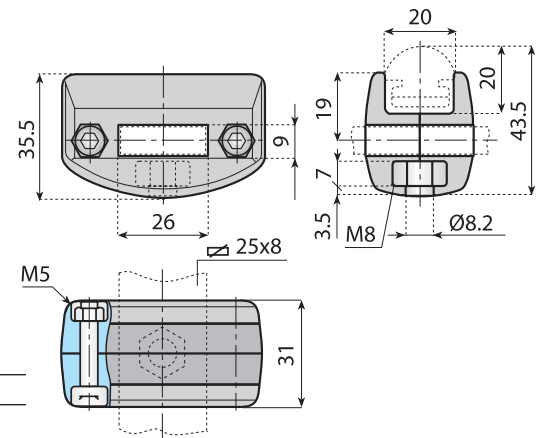

## DOUBLE CLAMP WITH ROD

**Material:** clamp in reinforced polyamide, nut and rod in stainless steel.

**Note:** code 13525 is supplied without rod.

**Supply:** unassembled.

**Packaging:** 50 pieces.

Code	DP
13525	-
13526	12
13527	14
13720	16

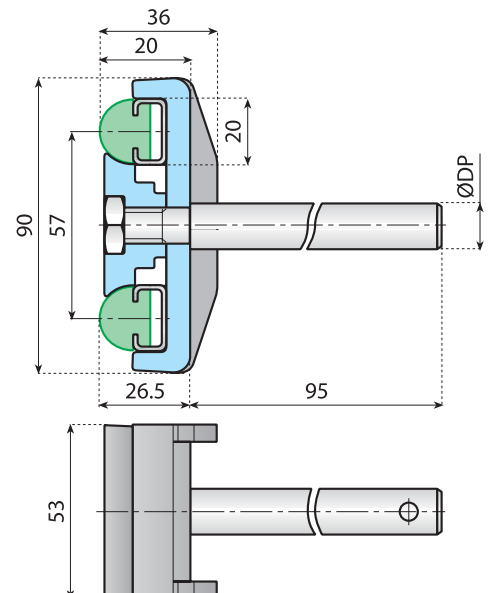

# Clamps for flat side guide



See page 98



304 Stainless steel



Consult pages 134 → 137 for rod design

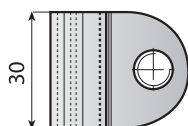
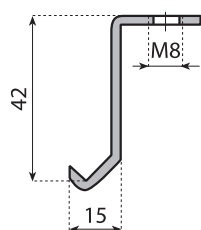
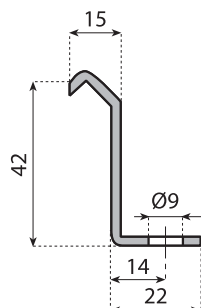

## FIXING CLAMP

**Material:** clamp in stainless steel.

**Thickness:**  $S = 3$  mm.

**Surface:** tumbling finish.

**Use:** with flat side guide code 19098 - 19098L

**Note:** the clamp is supplied without rod and bolt.

**Supply:** unassembled.

**Packaging:** 50 pieces.

Code

13994

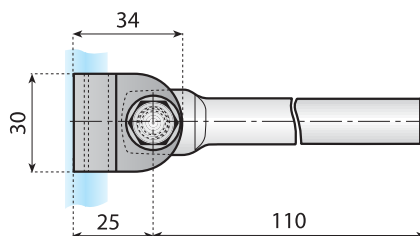
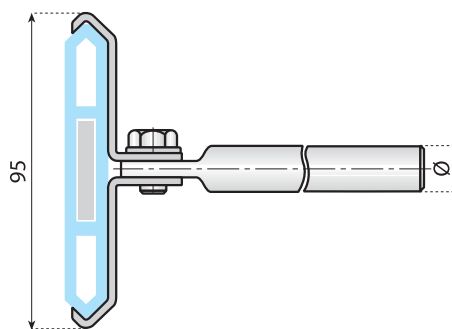

## FIXING CLAMP WITH ROD

**Material:** clamp, rod, screw and washer in stainless steel.

**Thickness:**  $S = 3$  mm.

**Surface:** tumbling finish.

**Use:** with flat side guide code 19098 - 19098L

**Supply:** unassembled.

**Packaging:** 50 pieces.

Code

13982

13983

13984

Rod Ø

12

14

16



# Accessories for flat side guides



Reinforced polyamide



See page 98

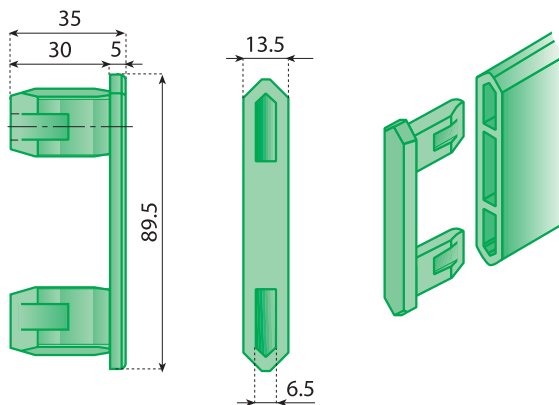

## END-PLUG

**Material:** reinforced polyamide.

**Use:** with flat side guide code 19098 - 19098L

**Packaging:** 10 pieces.

Code

13995

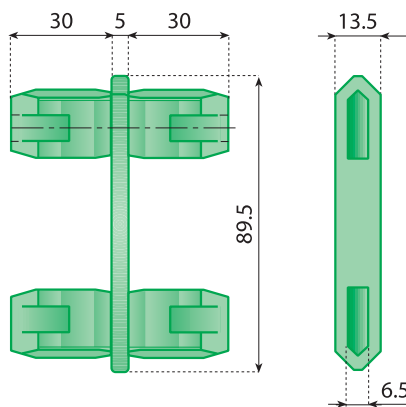
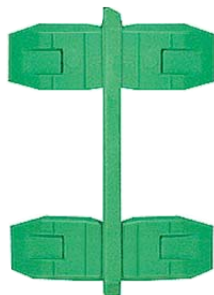

## CONNECTING PLUG

**Material:** reinforced polyamide.

**Use:** with flat side guide code 19098 - 19098L

**Packaging:** 10 pieces.

Code

13996

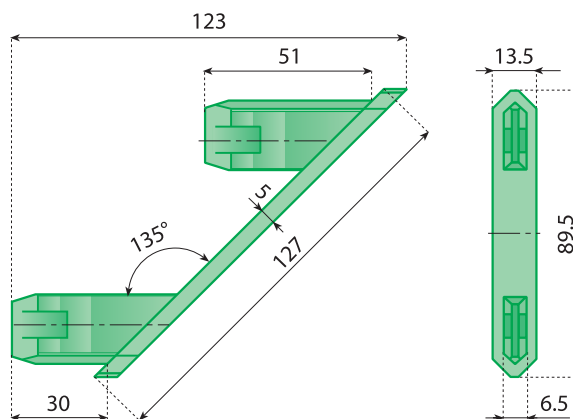
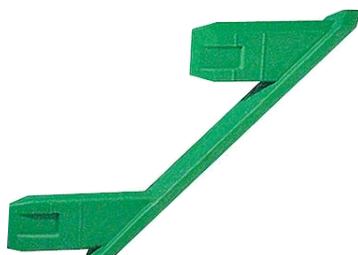

## END-PLUG

**Material:** reinforced polyamide.

**Use:** with flat side guide code 19098 - 19098L

**Packaging:** 10 pieces.

Code

13997

# Clamps for side guide (large type)



See page 99



304 Stainless steel



Consult pages 134 → 137 for rod design

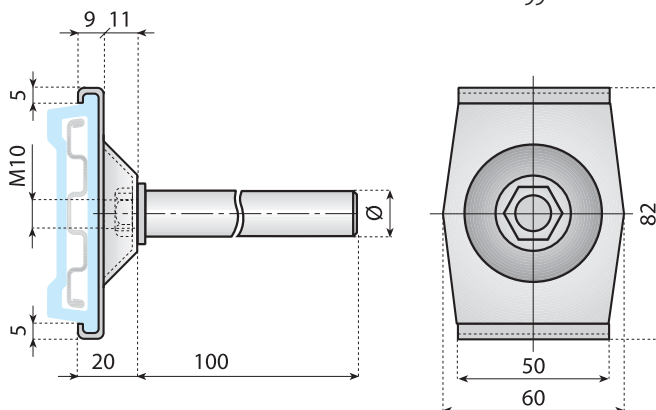
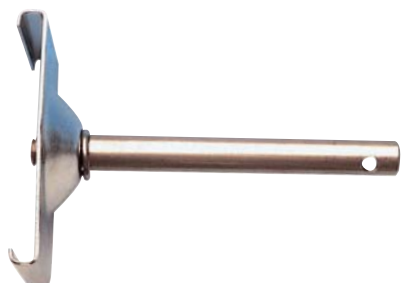

## FIXING CLAMP

One piece

**Material:** clamp, washer and rod in stainless steel AISI 304.

**Thickness:** S = 1.5 mm.

**Surface:** scotch brite finish.

**Note:** code 13171 is supplied without rod.

**Supply:** unassembled.

**Packaging:** 50 pieces.

Code	Rod Ø
13171	-
13172	12
13173	14
13174	16

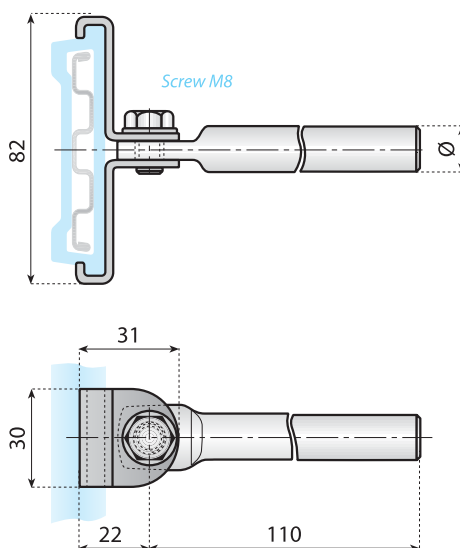

## FIXING CLAMP

Two pieces

**Material:** clamp, screws, washer and rod in stainless steel AISI 304.

**Thickness:** S = 3 mm.

**Surface:** tumbling finish.

**Note:** code 13834 is supplied without rod.

**Supply:** unassembled.

**Packaging:** 50 pieces.

Code	Rod Ø
13834	-
13985	12
13986	14
13987	16

# Accessories for side guide (large type)



See page 99



304 Stainless steel



Consult pages 134 → 137 for rod design

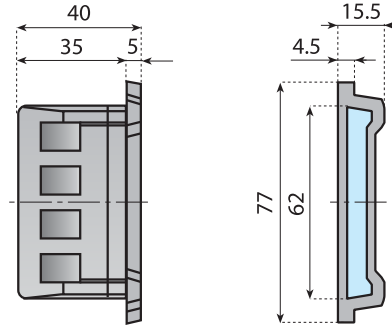

## END-PLUG

**Material:** reinforced polyamide.

**Use:** with side guide rails code 19082 - 19082L

**Packaging:** 10 pieces.

Code

13784

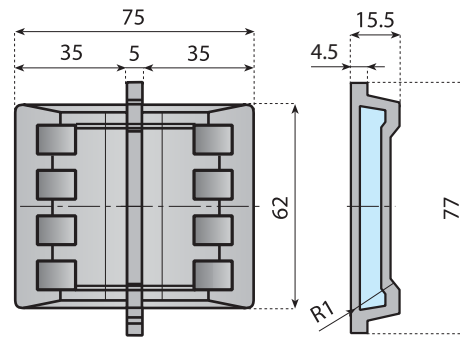

## PLUG

**Material:** reinforced polyamide.

**Use:** with side guide code 19082 - 19082L

**Packaging:** 10 pieces.

Code

13785

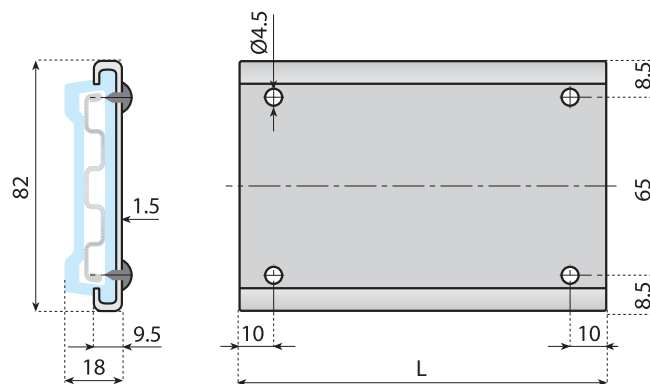

## COMBINER-CLAMP

**Material:** clamp and screws in stainless steel AISI 304.

**Thickness:** S = 1.5 mm.

**Surface:** scotch brite finish.

**Use:** with side guide code 19082 - 19082L

**Packaging:** 10 pieces, complete with fixing screws.

Code

13836

L

18333

100

150

# Clamps for side guide (extra large type)



See page 100



304 Stainless steel



Consult pages 134 → 137 for rod design

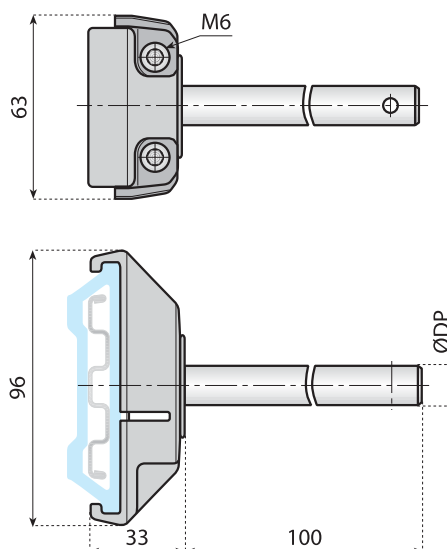

## CLAMPS

**Material:** clamp in reinforced polyamide, bolt and rod in stainless steel.

**Supply:** unassembled.

**Packaging:** 50 pieces.

**Note:** code 13718 is supplied without rod.

Code	DP
13718	-
13715	12
13716	14
13717	16

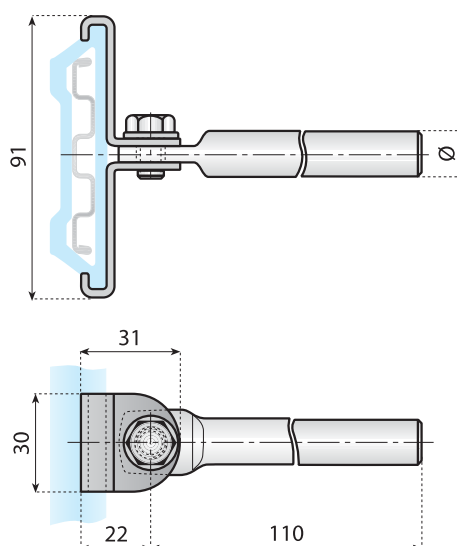
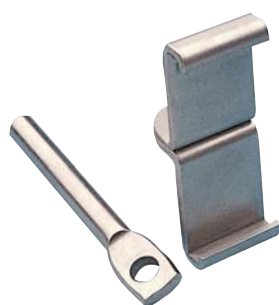

## FIXING CLAMP

**Material:** clamp screw, washer and rod in stainless steel AISI 304.

**Thickness:** S = 2 mm.

**Surface:** tumbling finish.

**Use:** with extra side guide code 19050 - 19050L.

**Note:** code 13835 is supplied without rod and bolt.

**Supply:** unassembled.

**Packaging:** 50 pieces.

Code	Rod Ø
13835	-
13494	12
13495	14
13496	16

# Accessories for side guides (extra large type)



See page 100



304 Stainless steel



Consult pages 134 → 137 for rod design

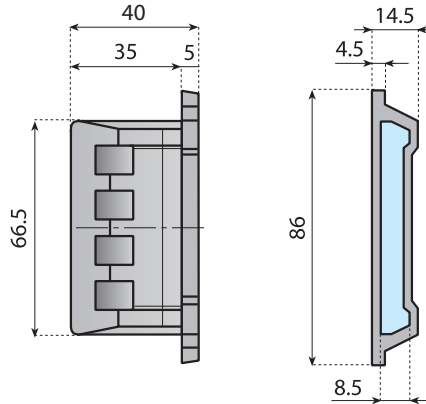

Code

13786

## END-PLUG

**Material:** reinforced polyamide.

**Use:** with extra side guide code 19050 - 19050L

**Packaging:** 10 pieces.

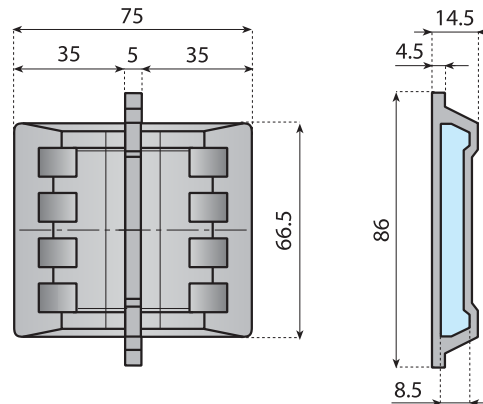

Code

13787

## COMBINER-PLUG

**Material:** reinforced polyamide.

**Use:** with extra side guide code 19050 - 19050L

**Packaging:** 10 pieces.

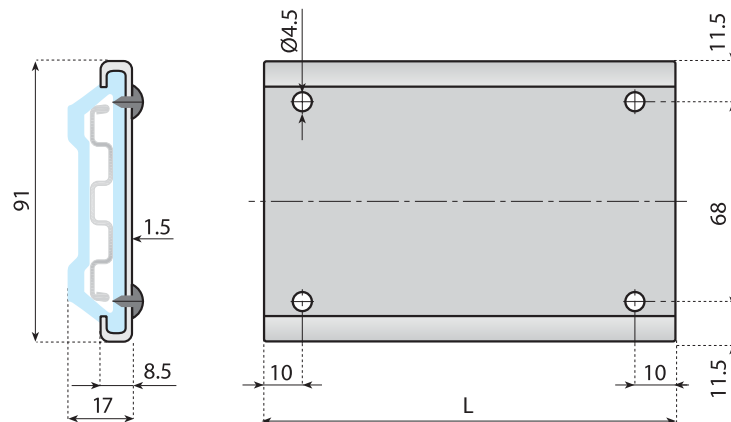

Code

13837

18334

L

100

150

## COMBINER-CLAMP

**Material:** clamp and screws in stainless steel AISI 304.

**Thickness:** S = 1.5 mm.

**Surface:** scotch brite finish.

**Use:** with extra side guide code 19050 - 19050L

**Packaging:** 10 pieces, complete with fixing screws.

# Clamps for round profile guides



*New design*

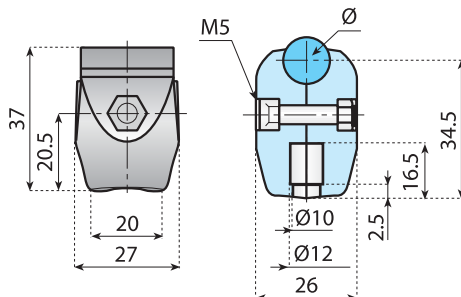

303 Stainless steel



Reinforced polyamide



Accessories



Consult see page 103 for rod profile



Consult pages 134 →137 for rod design

## SINGLE CLAMP

**Material:** clamp in reinforced polyamide, bolt in stainless steel nut in nickel plated brass.

**Supply:** assembled.

**Packaging:** 50 pieces.

Code	For guide Ø
13960	8
13961	10
13721	12
13725	14



*New design*

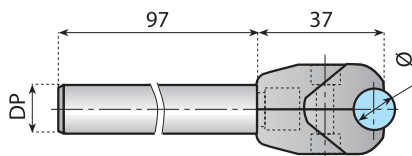

303 Stainless steel



Reinforced polyamide



Accessories

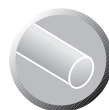

Consult see page 103 for rod profile



Consult pages 134 →137 for rod design

## SINGLE CLAMP WITH ROD

**Material:** clamp in reinforced polyamide, bolt in stainless steel nut in nickel plated brass, rod in stainless steel AISI 303.

**Supply:** assembled.

**Packaging:** 50 pieces.

Code	DP	For guide Ø
13962	12	8
13963	14	8
13964	16	8
13965	12	10
13966	14	10
13967	16	10
13722	12	12
13723	14	12
13724	16	12
13726	12	14
13727	14	14
13728	16	14

# Clamps for round profile guides



303 Stainless steel



Reinforced polyamide



Accessories



Consult see page 103 for rod profile



Consult pages 134 → 137 for rod design



*New design*

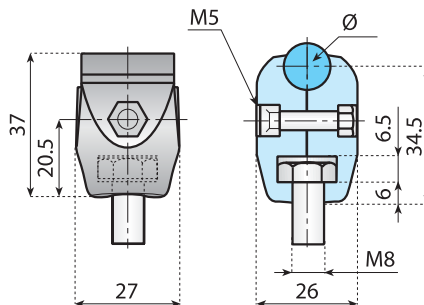

## SINGLE CLAMP

**Material:** clamp in reinforced polyamide, bolt in stainless steel nut in nickel plated brass.

**Supply:** assembled.

**Packaging:** 50 pieces.

Code	For guide Ø
13968	8
13969	10
13729	12
13733	14



*New design*



303 Stainless steel



Reinforced polyamide



Accessories



Consult see page 103 for rod profile



Consult pages 134 → 137 for rod design

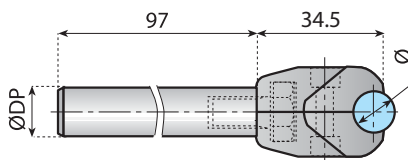

## SINGLE CLAMP WITH ROD

**Material:** clamp in reinforced polyamide, bolt in stainless steel nut in nickel plated brass, rod in stainless steel AISI 303.

**Supply:** assembled.

**Packaging:** 50 pieces.

Code	DP	For guide Ø
13970	12	8
13971	14	8
13972	16	8
13973	12	10
13974	14	10
13975	16	10
13730	12	12
13731	14	12
13732	16	12
13734	12	14
13735	14	14
13736	16	14



# Clamps for round profile guides



304 Stainless steel



Reinforced polyamide



Accessories



Consult see page 103 for round profile



Consult pages 134 → 137 for rod design

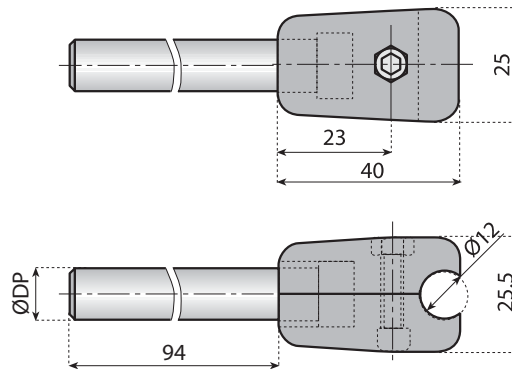

## SINGLE CLAMP

**Material:** clamp in reinforced polyamide, bolt and rod in stainless steel nut in nickel plated brass.

**Supply:** assembled.

**Packaging:** 50 pieces.

**Note:** code 13745 is supplied without rod.

Code	DP
13745	-
13977	12
13978	14
13979	16



304 Stainless steel



Reinforced polyamide

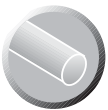

Consult see page 103 for round profile

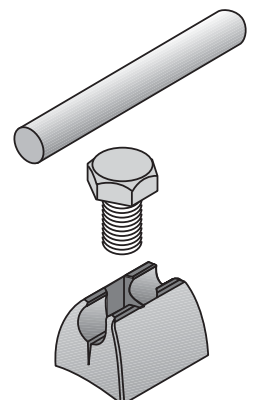
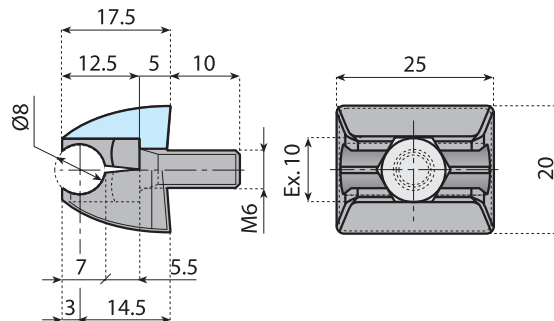

## CLIP-ON SINGLE CLAMP

**Material:** clamp in polyamide, bolt stainless steel

**Use:** with round profile guide Ø8 mm.

**Supply:** assembled.

**Packaging:** 100 pieces.

Code
13980

# Clamps for round profile guides



304 Stainless steel



Reinforced polyamide



Accessories



Consult see page 103 for rod profile



Consult pages 134 → 137 for rod design

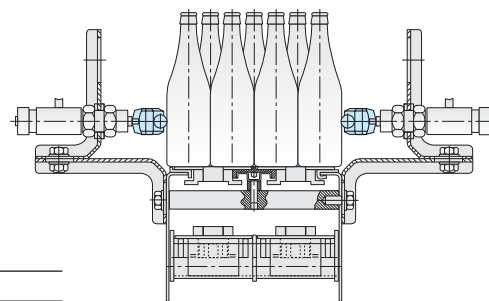
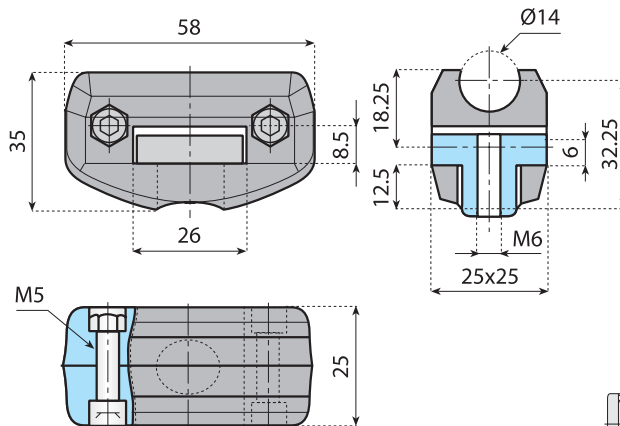

## SINGLE CLAMP

**Material:** clamp in reinforced polyamide, bolt in stainless steel, nut and threaded bushing in nickel plated brass.

**Use:** with round profile guide Ø14 mm.

**Supply:** assembled.

**Packaging:** 50 pieces.

Code

13742



304 Stainless steel



Reinforced polyamide



Consult see page 103 for rod profile



Accessories

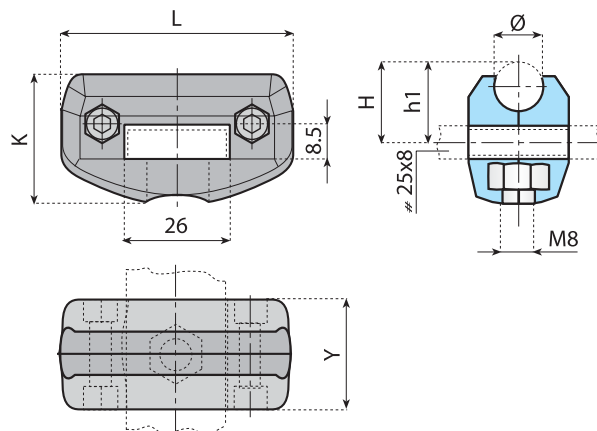

Range extension

## ADJUSTABLE CLAMP

**Material:** clamp in reinforced polyamide, bolt in stainless steel, nut in nickel plated brass.

**Supply:** assembled.

**Packaging:** 50 pieces.

Code

Code	Ø	L	K	Y	H	h1
13743	8	58	33	21	18	16
13741	10	58	33	21	18.5	16
13744NV	12	59	34.5	24	21	19
13740	14	58	34	25	22	17.5

# Clamps for round profile guides

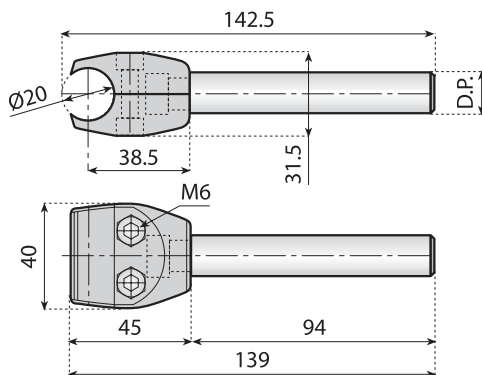

## DOUBLE CLAMP WITH ROD

**Material:** clamp in reinforced polyamide, bolt nut and rod in stainless steel.

**Supply:** assembled.

**Packaging:** 50 pieces.

**Note:** code 13771 is supplied without rod.

Code	DP
13771	-
13772	12
13773	14
13774	16



304 Stainless steel



Reinforced polyamide

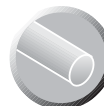

Consult see page 103 for rod profile



Consult pages 134 → 137 for rod design

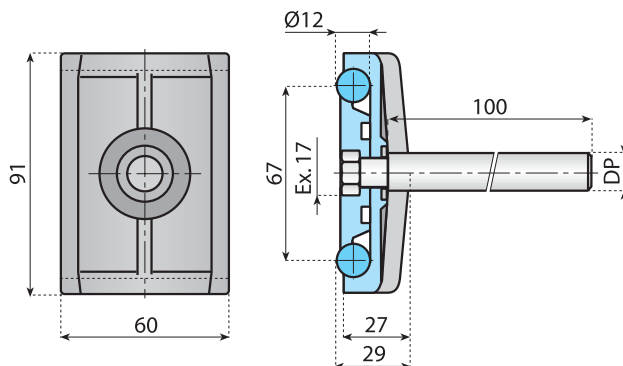

## DOUBLE CLAMP WITH ROD

**Material:** clamp in reinforced polyamide, nut and rod in stainless steel.

**Supply:** assembled.

**Packaging:** 50 pieces.

**Note:** code 13761NV is supplied without rod.

Code	DP
13761NV	-
13770NV	12
13772NV	14
13773NV	16

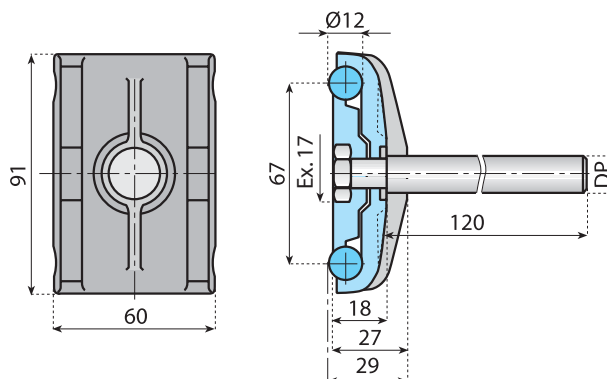

## DOUBLE CLAMP WITH ROD

**Material:** clamp in reinforced polyamide, nut and rod in stainless steel.

**Supply:** assembled.

**Packaging:** 50 pieces.

**Note:** code 13761 is supplied without rod.

Code	DP
13761	-
13770	12
13762	14
13763	16

# Clamps for round profile guides

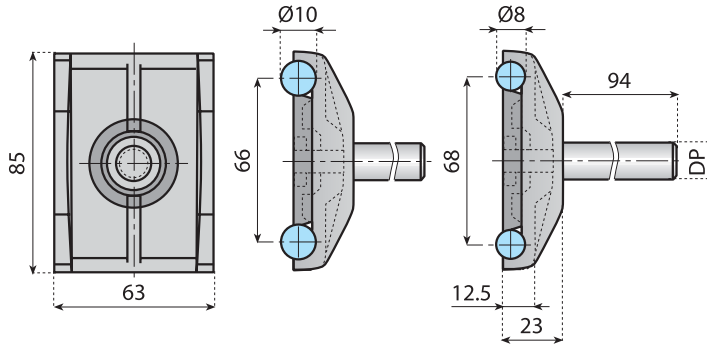

## DOUBLE CLAMP FOR ROUND PROFILE GUIDES Ø 8-10 mm

**Material:** clamp in reinforced polyamide bolt, nut and rod in stainless steel.

**Note:** code 13754 is supplied without rod.

**Use:** round profile guides (8 or 10 mm) can be used simply turning the flange position.

**Packaging:** 50 pieces.

Code	DP
13754	-
13755	12
13756	14
13757	16

Flange position for assembling guides with diam. d = 8 mm.

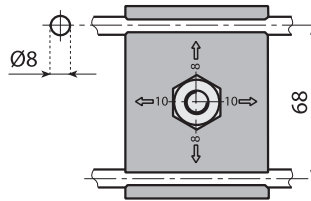

Flange position for assembling guides with diam. d = 10 mm.

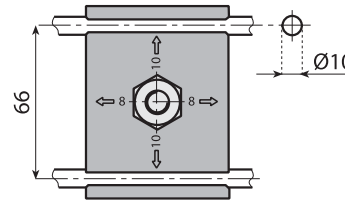

*Application example*

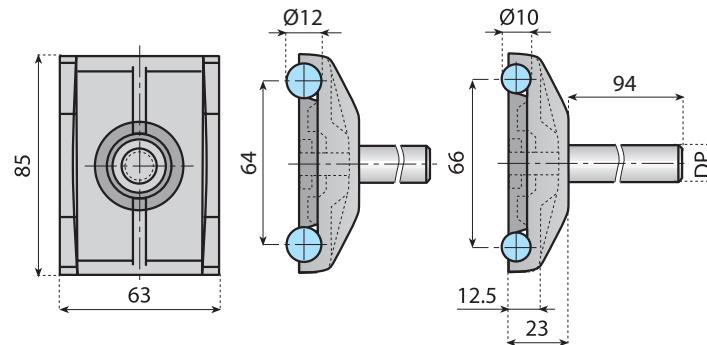

## DOUBLE CLAMP FOR ROUND PROFILE GUIDES Ø 10-12 mm

**Material:** clamp in reinforced polyamide bolt, nut and rod in stainless steel AISI 304

**Note:** code 13777 is supplied without rod.

**Use:** round profile guides (10 or 12 mm) can be used simply turning the flange position.

**Packaging:** 50 pieces.

Code	DP
13777	-
13778	12
13779	14
13780	16

Flange position for assembling guides with diam. d = 10 mm

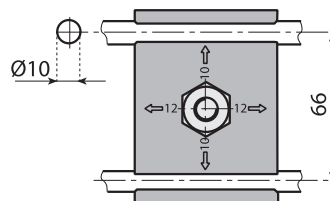

Flange position for assembling guides with diam. = 12 mm

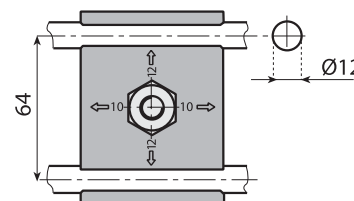

*Application example*



304 Stainless steel



Reinforced polyamide



Consult see page 103 for round profile



Consult pages 134 → 137 for round design



Accessories

# Adjusting rods

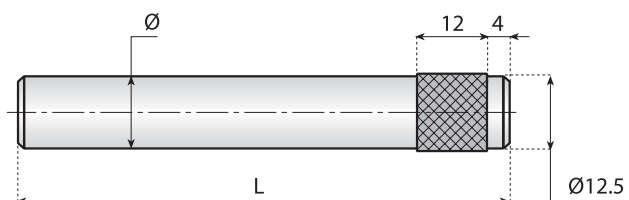

## ADJUSTING RODS

**Material:** stainless steel AISI 303.

**Packaging:** 50 pieces.

**Use:** with code 13006 - 13745 - 13771

Code	Ø	L
13901	12	110
13902	12	160

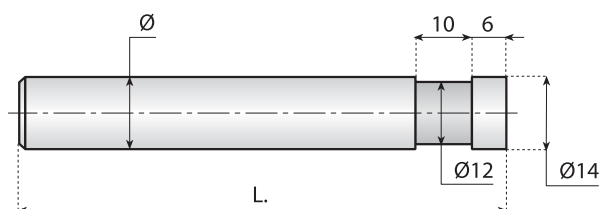

## ADJUSTING RODS

**Material:** stainless steel AISI 303.

**Packaging:** 50 pieces.

**Use:** with code 13006 - 13745 - 13771

Code	Ø	L
13903	14	110
13904	14	160
13905	16	110
13906	16	160

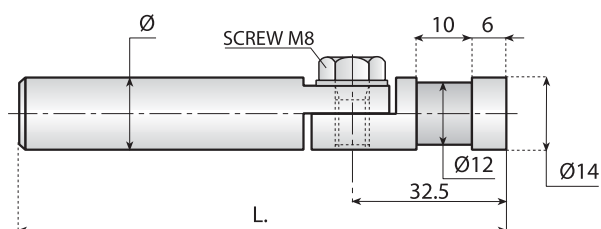

## ADJUSTING RODS

**Material:** stainless steel AISI 303.

**Packaging:** 50 pieces.

**Use:** with code 13006 - 13745 - 13771

Code	Ø	L
13775	16	150
13776	16	250

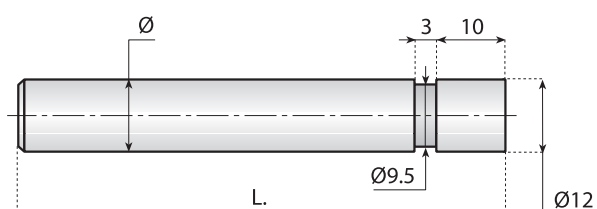

## ADJUSTING RODS

**Material:** stainless steel AISI 303.

**Packaging:** 50 pieces.

**Use:** with code 13788 - 13002 - 13721 - 13725

Code	Ø	L
13933	12	110
13934	12	160
13935	14	110
13936	14	160
13937	16	110
13938	16	160

# Adjusting rods

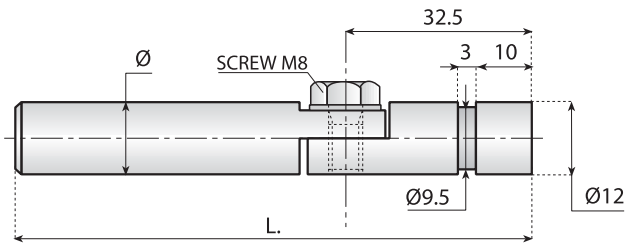

## ADJUSTING RODS

**Material:** stainless steel AISI 303.

**Packaging:** 50 pieces.

**Use:** with code 13788 - 13001 - 13721 - 13725

Code	Ø	L
13939	16	150
13940	16	250

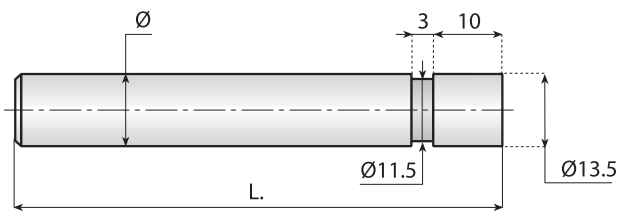

## ADJUSTING RODS

**Material:** stainless steel AISI 303.

**Packaging:** 50 pieces.

**Use:** with code 13006NV

Code	Ø	L
13907	14	110
13908	14	160
13909	16	110
13910	16	160

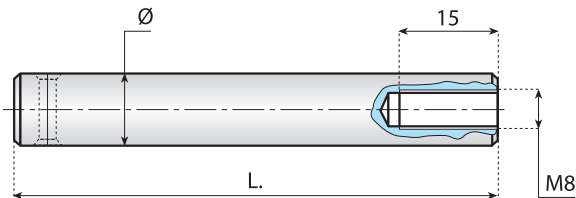

## ADJUSTING RODS

**Material:** stainless steel AISI 303.

**Packaging:** 50 pieces.

**Use:** with code 13012 - 13013 - 13014  
13792 - 13184 - 13729 - 13733

Code	Ø	L
13911	12	80
13912	12	100
13913	12	150
13914	14	100
13915	14	150
13916	16	100
13917	16	150

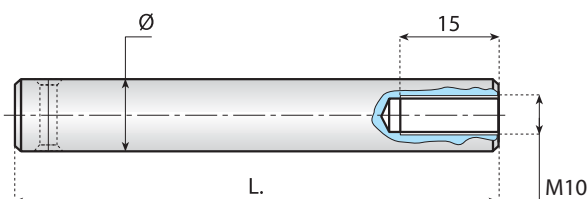

## ADJUSTING RODS

**Material:** stainless steel AISI 303.

**Packaging:** 50 pieces.

Code	Ø	L
131130	14	120
131131	14	170
131132	16	120
131134	16	95
131133	16	170

# Adjusting rods

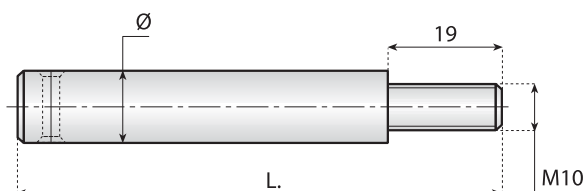

## ADJUSTING RODS

**Material:** stainless steel AISI 303.

**Packaging:** 50 pieces.

**Use:** with code 13008NV - 13777 - 13761  
13163 - 13754 - 13718 - 13761NV

Code	$\varnothing$	L
13918	12	120
13919	12	170
13920	14	120
13921	14	170
13922	16	120
13923	16	170

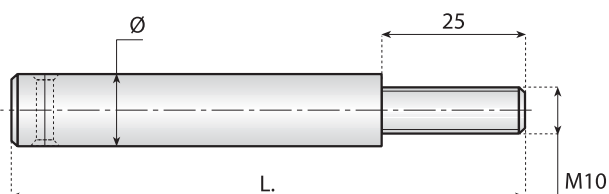

## ADJUSTING RODS

**Material:** stainless steel AISI 303.

**Packaging:** 50 pieces.

**Use:** with code 13525.

Code	$\varnothing$	L
13941	12	120
13942	12	170
13943	14	120
13944	14	170
13945	16	120
13946	16	170

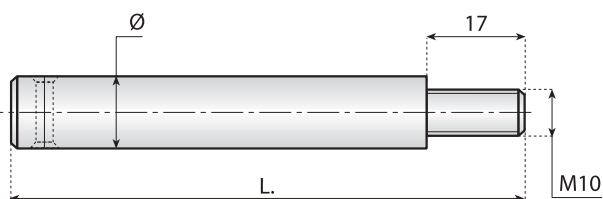

## ADJUSTING RODS

**Material:** stainless steel AISI 303.

**Packaging:** 50 pieces.

**Use:** with code 13171.

Code	$\varnothing$	L
13947	12	120
13948	12	170
13950	14	120
13951	14	170
131135	16	104
13952	16	120
13953	16	170

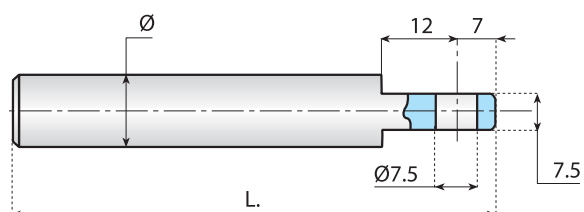

## ADJUSTING RODS

**Material:** stainless steel AISI 303.

**Packaging:** 50 pieces.

**Use:** with code 13167.

Code	$\varnothing$	L
13924	12	120
13925	12	170
13926	14	120
13927	14	170
13928	16	120
13929	16	170



# Adjusting rods

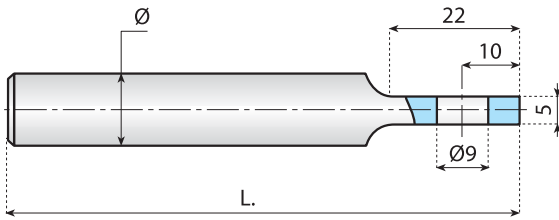

## ADJUSTING RODS

**Material:** stainless steel AISI 303.

**Packaging:** 50 pieces.

**Use:** with code 13829 - 13850 - 13800 - 13833.

Code	Ø	L
13954	12	120
13955	12	170
13956	14	120
13957	14	170
13958	16	120
13959	16	170

## ADJUSTING RODS

**Material:** stainless steel AISI 303.

**Packaging:** 50 pieces.

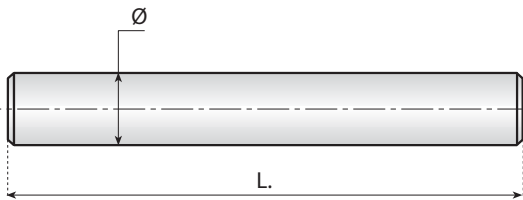

Code	Ø	L
131112	12	200
131113	12	250
131114	12	300
131115	14	200
131116	14	250
131117	14	300
131118	16	100
131119	16	150
131120	16	250
131121	16	300
131122	20	250
131123	20	350

## ADJUSTING RODS

**Material:** stainless steel AISI 303.

**Packaging:** 50 pieces.

**Use:** with code 190265 - 190265F

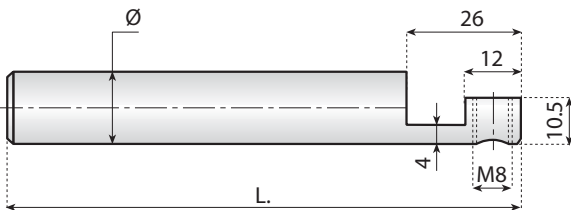

Code	Ø	L
131124	14	200
131125	14	250
131126	16	200
131127	16	250

# Universal clamp for photocells or reflectors



304 Stainless steel



Nickel plated brass



Polyamide



Accessories



Code	For rod Ø
13616H	14
13617H	15
13618H	16
13619H	18
13620H	20

*Movement on the three axis*

## UNIVERSAL CLAMP WITH ADJUSTABLE HANDLE FOR PHOTOCELLS OR REFLECTORS

**Material:** clamp in reinforced polyamide, tightening bolt in stainless steel, adjustable handle in polyamide with threaded insert in nickel plated brass.

**Supply:** assembled.

**Packaging:** 50 pieces.

**Note:** max recommended tightening torque 2 Kgm.

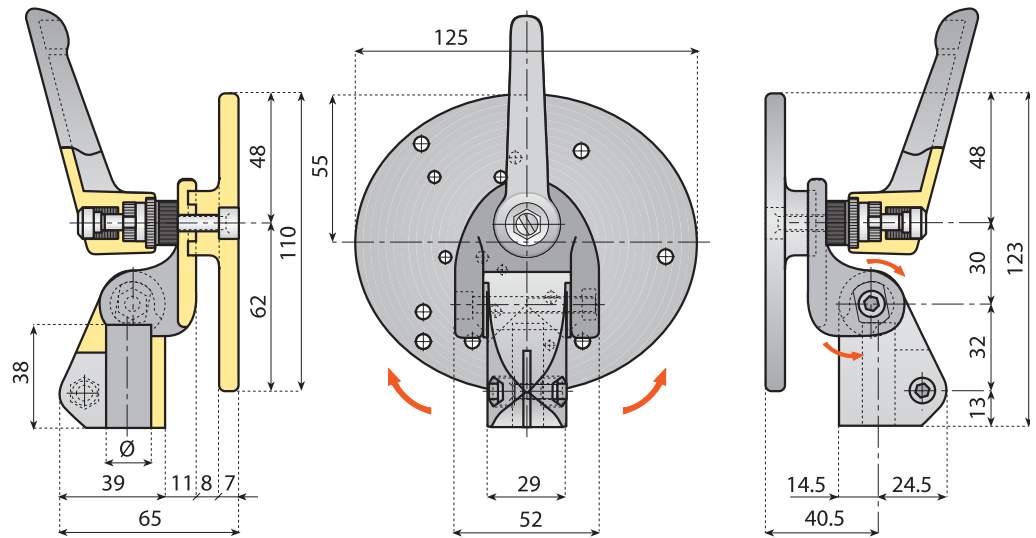

Code	For rod Ø
13616	14
13617	15
13618	16
13619	18
13620	20



*Movement on the three axis*

## UNIVERSAL CLAMP FOR PHOTOCELLS OR REFLECTORS

**Material:** clamp in reinforced polyamide, tightening bolt in stainless steel.

**Supply:** assembled.

**Packaging:** 50 pieces.

**Note:** max recommended tightening torque 2 Kgm.

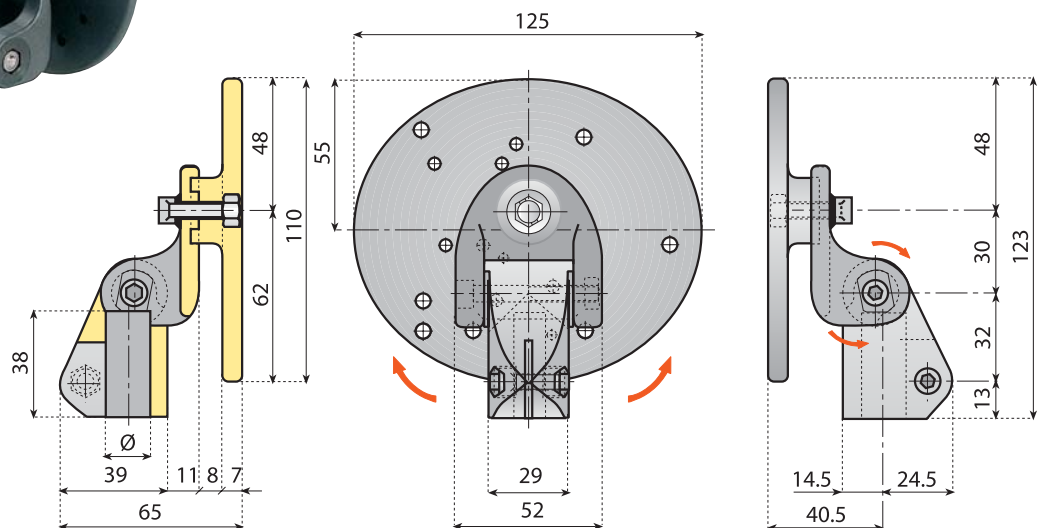

# Suitable photocell types

PRK 95 LEUZE

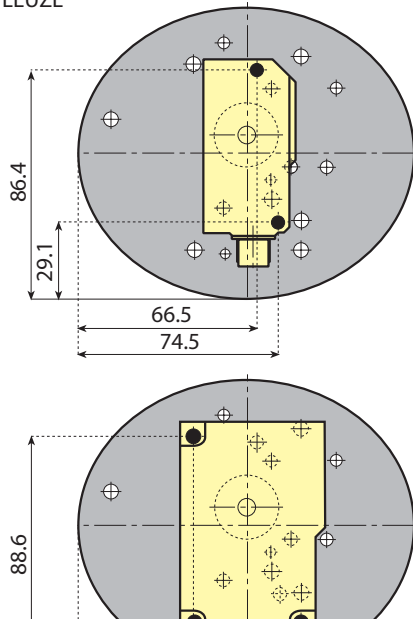

WT12 SICK

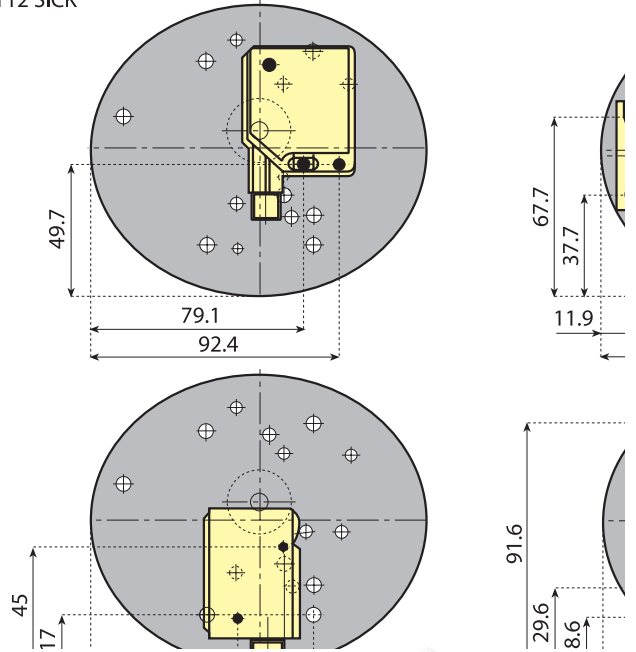

## KIT UNIVERSAL CLAMP FOR PHOTOCELLS OR REFLECTORS WITH TUBE

**Material:** cross clamp in reinforced polyamide, tightening bolt and tube in stainless steel.

**Supply:** assembled.

**Packaging:** 50 pieces.

**Note:** max recommended tightening torque 2 Kgm.

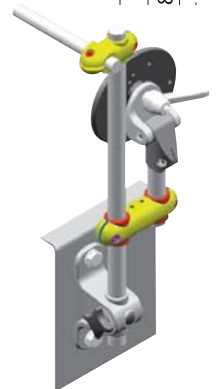

*Movement on the three axis*

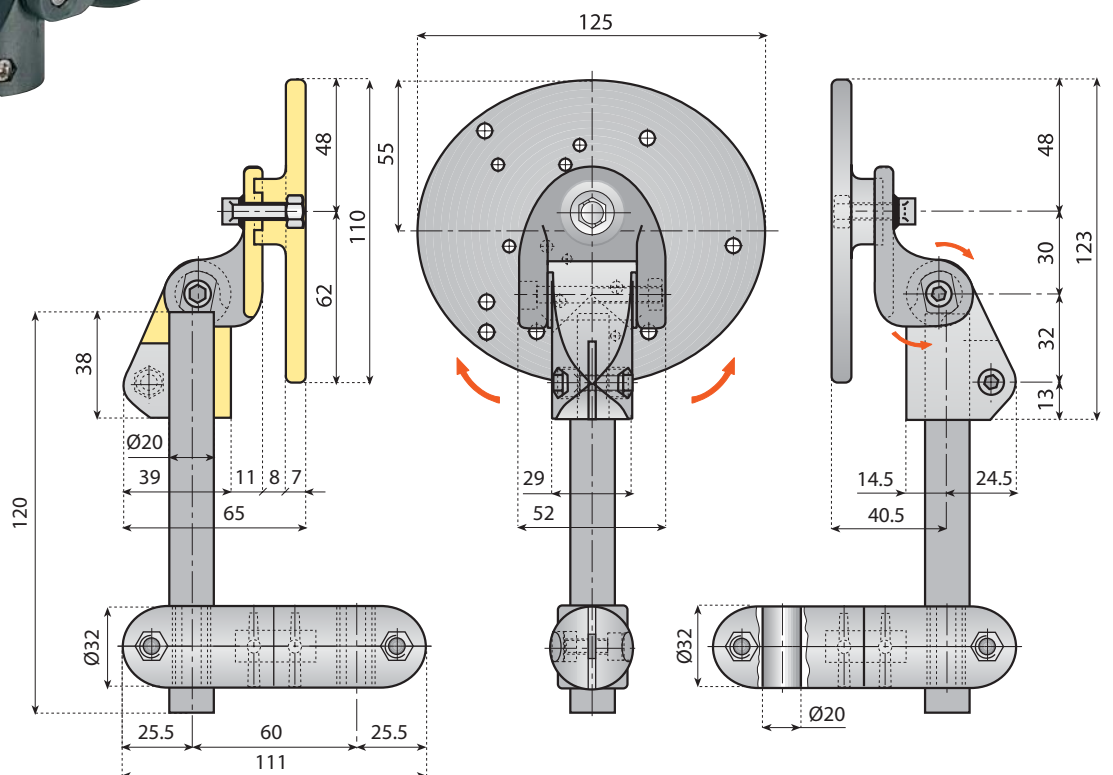

Code	For rod Ø
13615	20

# Clamp for photocells or reflectors



304 Stainless steel Polyamide

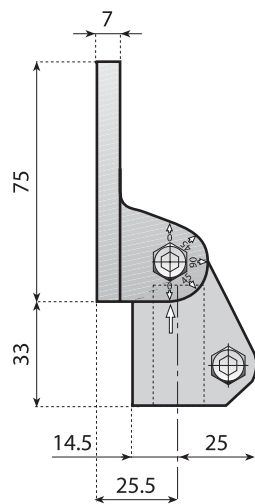

*Pos. A*

## CLAMP FOR PHOTOCELLS OR REFLECTORS

**Material:** reinforced polyamide, tightening bolts in stainless steel AISI 304.

**Use:** can be fitted in position **A - B - C**

**Supply:** assembled, (position A).

**Packaging:** 50 pieces.

Code	For rod Ø
13500	14
13505	15
13506	16
13507	18
13508	20

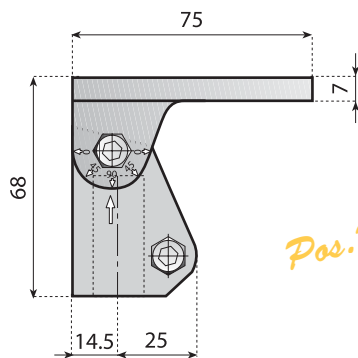

*Pos. B*

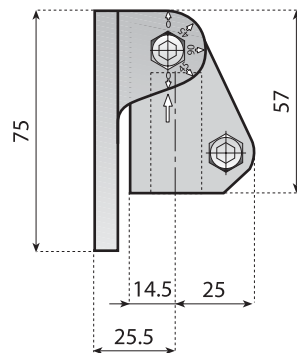

*Pos. C*

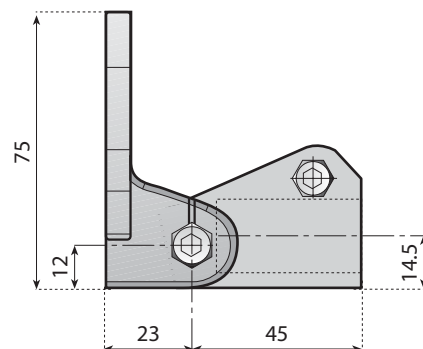
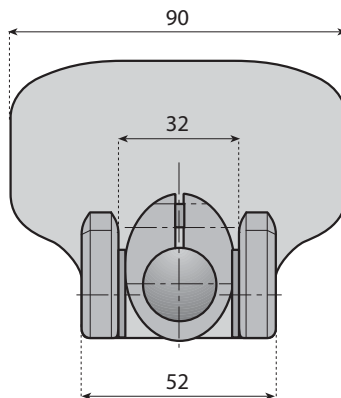
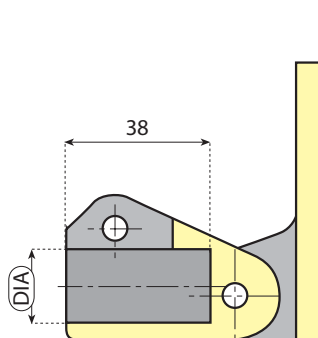
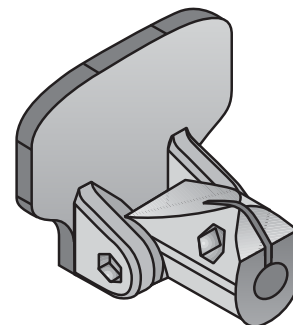

# Photocell accessories



304 Stainless steel



Nickel plated brass



Polyamide

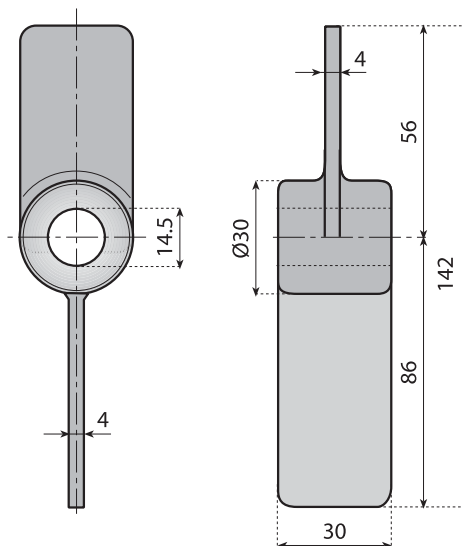

## BOTTLE INDICATOR

**Material:** reinforced polyamide.

**Application:** activation of photocells on conveyors and machines.

**Packaging:** 50 pieces.

Code

13150

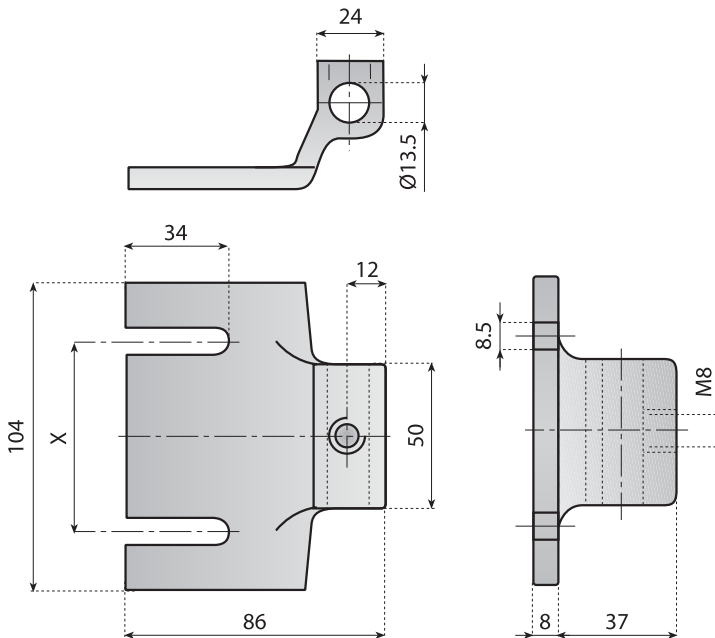

## CLAMP BRACKET OVER HEAD

**Material:** bracket in reinforced polyamide, threaded bushing in nickel plated brass.

**Packaging:** 50 pieces.

Code

13846

X

13899

55

64.5



304 Stainless steel



Polyamide

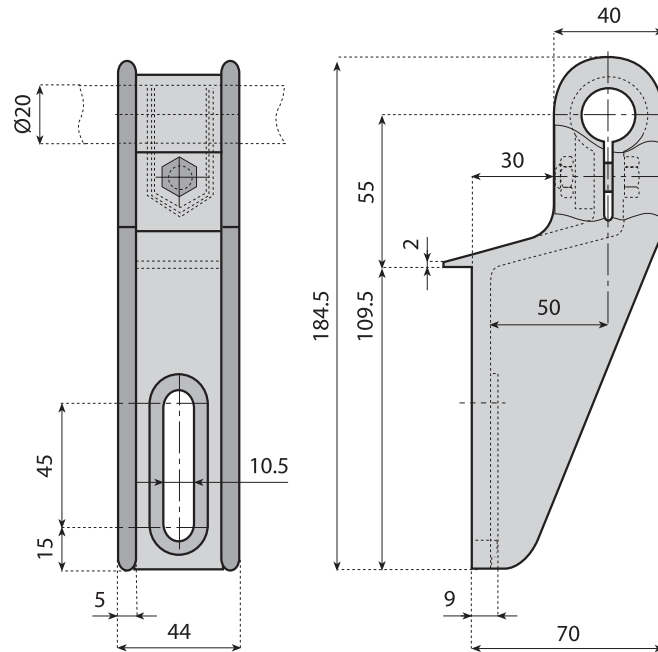

### SIDE BRACKET FOR HORIZONTAL TUBES

**Material:** bracket in reinforced polyamide, nut, bolt and washers in stainless steel AISI 304.

**Supply:** assembled.

**Packaging:** 50 pieces.

Code

13898

# Split shafting collars

## SPLIT SHAFTING COLLAR

**Material:** acetal resin, bolts in stainless steel, threaded insert in nickel plated brass.

**Use:** these parts can be used on the conveyors as a reference point when the side guides need to be repositioned.

**Note:** The new collars offer high corrosion resistance. The new part exhibits high strength at considerably less cost than stainless steel.

The new collars are the ideal replacement for conventional collars in situation where they cannot be easily removed and replaced.

**Supply:** assembled.

**Packaging:** 100 pieces.



Acetal resin



304 Stainless steel



Nickel plated brass

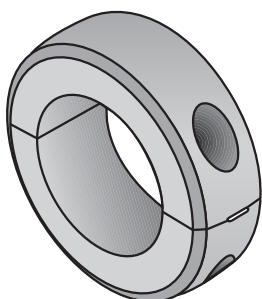
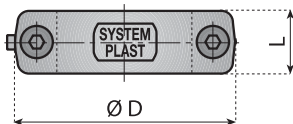
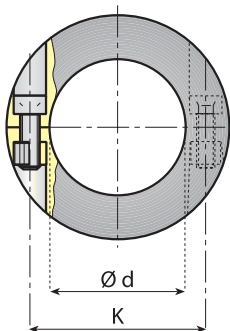
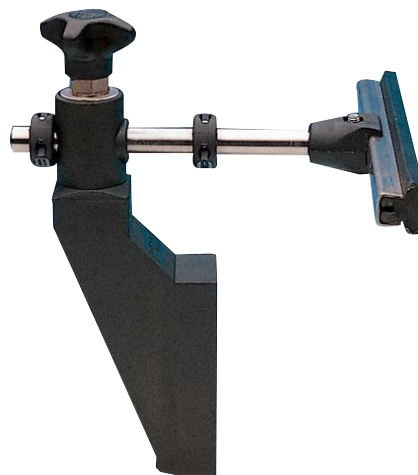
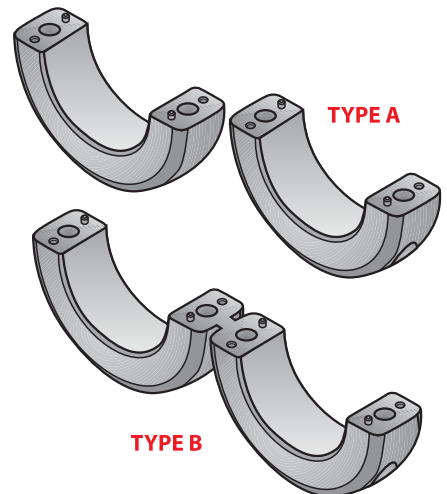

Code	Type	d	D	L	K	Screws
12696	B	10	30	12	20	M3
12698	A	12	30	12	20	M3
12700	A	14	28	12	20	M3
12697	B	15	39	14	27	M4
12701	A	16	30	12	22	M3
12699	A	18	39	14	27	M4
12702	A	20	39	14	29	M4
12703	A	25	44	14	34	M4
12704	A	30	49	16	39	M4
12714	B	30	49	14	39	M4
12705	A	35	56	16	45	M4
12706	A	40	64	18	51.5	M5
12715	B	40	64	14	51.5	M4



# Split shafting collars for shaft with keyway



Acetal resin



304 Stainless steel



Nickel plated brass



Polyamide



Range extension

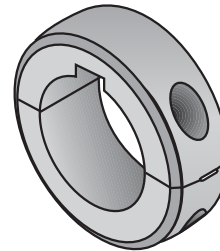
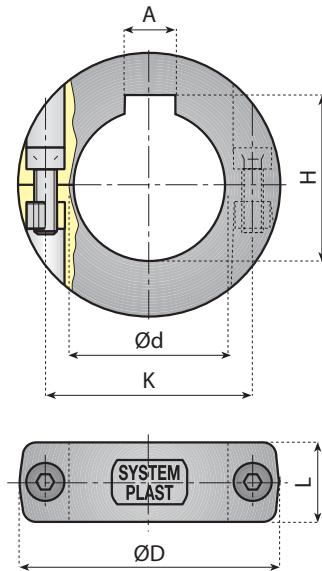

## SPLIT SHAFTING COLLAR

**Material:** reinforced polyamide, screws in stainless steel, threaded insert in nickel plated brass.

**Use:** for shaft with key way.

**Supply:** assembled.

**Packaging:** 100 pieces.

Code	d	D	A	H	L	K	Screws	
12710	25	45	8	P9	28.3 <sup>+0.2</sup> <sub>0</sub>	14	34	M4
12709	30	50	8	P9	33.3 <sup>+0.2</sup> <sub>0</sub>	16	39	M4
12708	35	57	10	P9	38.3 <sup>+0.2</sup> <sub>0</sub>	16	45	M4
12707	40	64	12	P9	43.3 <sup>+0.2</sup> <sub>0</sub>	18	51.5	M5

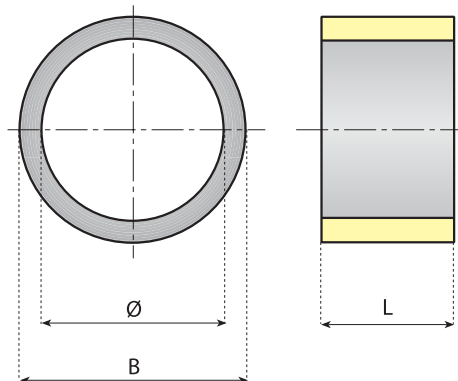
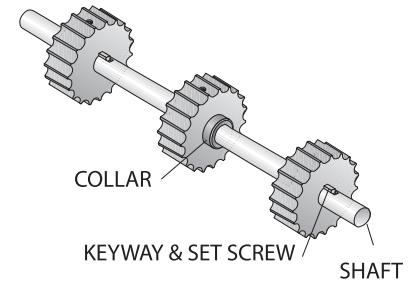

## IDLER SPACER

**Material:** polyamide.

**Packaging:** 50 pieces.

Code	For shaft Ø	B	L
12829	30	40	29
12830	40	50	29

# Drip tray supports



## DRIP TRAY SUPPORTS

**Material:** metal support in stainless steel AISI 304, clamp in polyamide.

**Accessories:** fixing washer code 13252

**Application:** drip tray supports can be used with the following brackets:

13020 - 13021 - 13022 - 13023 - 13024 - 13025 - 13026 - 13027  
 13050 - 13051 - 13052 - 13054 - 13055 - 13056 - 13088 - 13089  
 13205 - 13206 - 13207 - 13746 - 13747 - 13748 - 13749 - 13750  
 13751 - 13767 - 13768 - 13200 - 13201 - 13692 - 13693 - 13696  
 13697 - 13769 - 13632 - 13633 - 13634 - 13635 - 13208 - 13209  
 13210.

Drip tray supports can also be used with spacers code:  
 13019 - 13399 - 13400.

**Packaging:** 50 pieces.

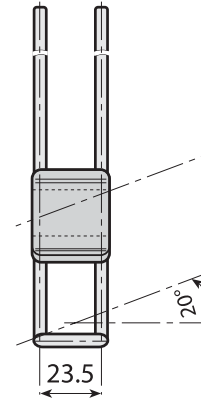

304 Stainless steel



Polyamide



Accessories

## DRIP TRAY SUPPORTS - AVAILABLE VERSIONS

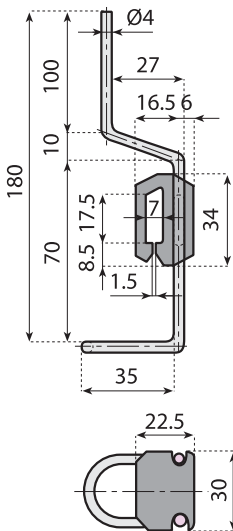

Code **13250** L 184 mm

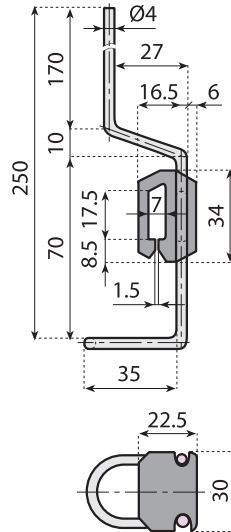

Code **13253** L 254 mm

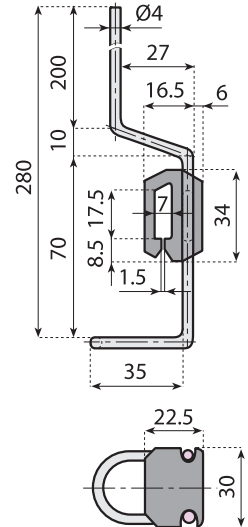

Code **13254** L 284 mm

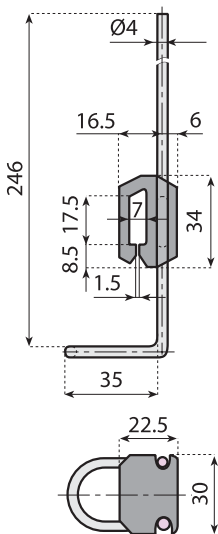

Code **13255** L 250 mm

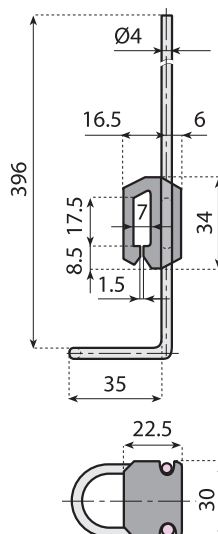

Code **13256** L 400 mm

# Drip tray supports



## DRIP TRAY SUPPORTS

**Material:** metal support in stainless steel AISI 304, clamp in polyamide.

**Accessories:** fixing washer code 13252

**Application:** drip tray supports can be used with the following brackets:

13020 - 13021 - 13022 - 13023 - 13024 - 13025 - 13026 - 13027  
 13050 - 13051 - 13052 - 13054 - 13055 - 13056 - 13088 - 13089  
 13205 - 13206 - 13207 - 13746 - 13747 - 13748 - 13749 - 13750  
 13751 - 13767 - 13768 - 13200 - 13201 - 13692 - 13693 - 13696  
 13697 - 13769 - 13632 - 13633 - 13634 - 13635 - 13208 - 13209  
 13210.

Drip tray supports can also be used with spacers code:  
 13019 - 13399 - 13400.

**Packaging:** 50 pieces.

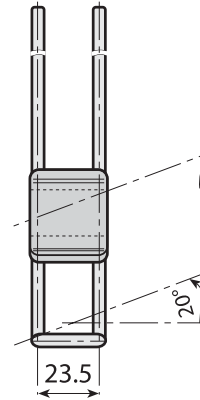

304 Stainless steel



Polyamide



Accessories

## DRIP TRAY SUPPORTS - AVAILABLE VERSIONS

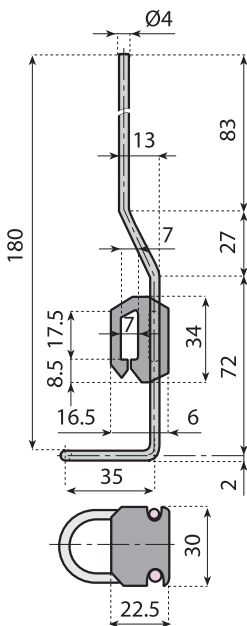

Code L  
**13257** 184 mm

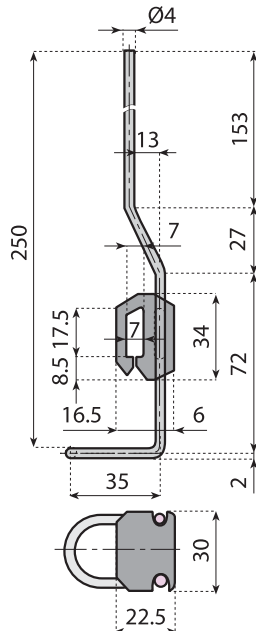

Code L  
**13258** 254 mm



## FIXING WASHER

**Material:** polyamide, washer in stainless steel AISI 304.

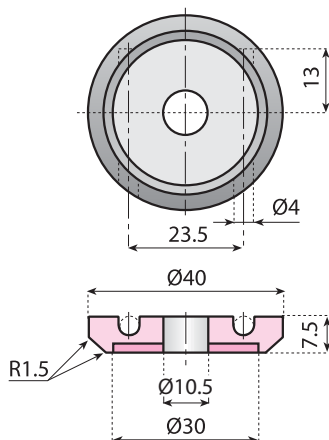

Code  
**13252**

