

COMPACT CORNER TRACKS for chains series

879 - 880 - 881 - 881O



For steel chains, type:
• 881 • 881O • 881 VG



For plastic chains, type:
• 879 • 880



Inserts: The corner tracks can be supplied with M8 or M10 brass inserts to your detailed drawing.



Corner tracks Special Dimensions: On request corner tracks with special dimensions can be produced.

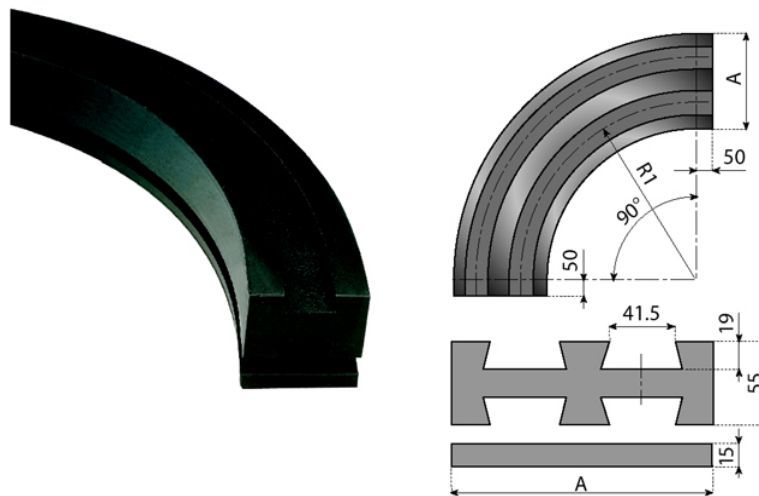

FOR CHAINS WIDTH	CODE	A	R1	PITCH
K325	19106B	100	500	90
	19107B	190		
K450	19108B	130	610	120
	19109B	250		

Material: Ultra High Molecular Weight Polyethylene to provide minimum friction and reliable long term performance.

Note: max. continuous service temperature in air 90°C. Water absorption coefficient = 0.

Colour: black.

Supply: 2 pieces.

Other Series:

[- 879 - 880 - 881 - 881O Corner Tracks](#)

[- 882 BEVEL](#)

CORNER TRACKS for chains series

882 BEVEL



For plastic chains, type:
• 882 BEVEL



Inserts: The corner tracks can be supplied with M8 or M10 brass inserts to your detailed drawing.



Corner tracks Special Dimensions: On request corner tracks with special dimensions can be produced.

More tracks available on request.

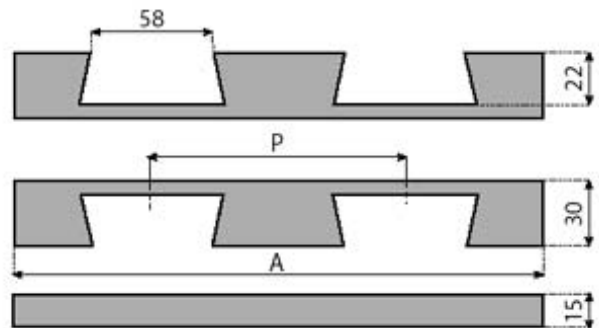
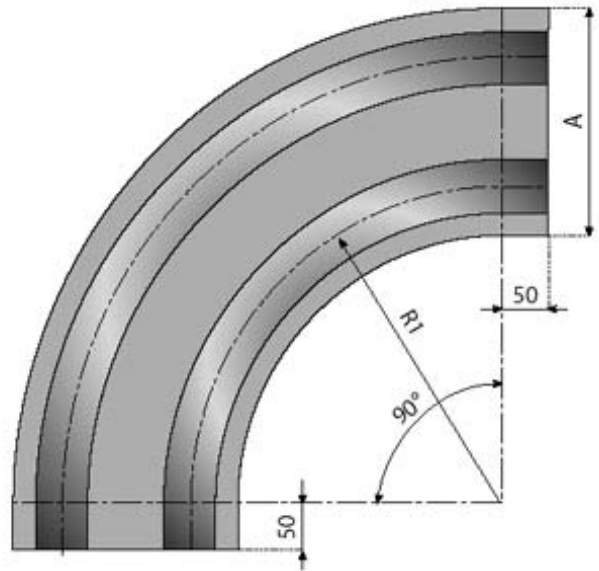
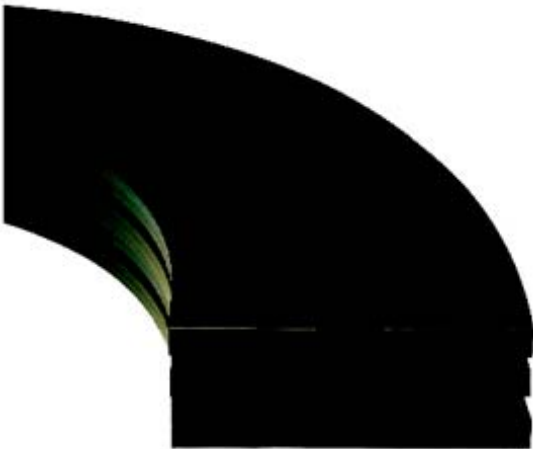
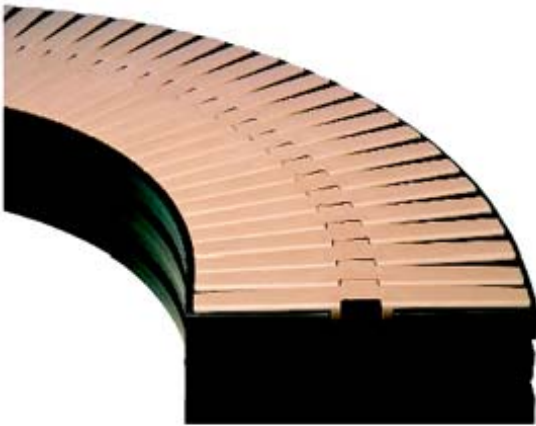

BEVEL CHAINS K450 Pitch 120 mm					
TRACKS	Total Width TL mm	Radius R1=610	Radius R1=650	Radius R1=800	Radius R1=1000
1	130	190001	190007	190013	190019
2	250	190002	190008	190014	190020
3	370	190003	190009	190015	190021
4	490	190004	190010	190016	190022
5	610	190005	190011	190017	190023
6	730	190006	190012	190018	190024

BEVEL CHAINS K750 Pitch 195 mm					
TRACKS	Total Width TL mm	Radius R1=610	Radius R1=650	Radius R1=800	Radius R1=1000
1	200	190025	190029	190033	190037
2	395	190026	190030	190034	190038
3	590	190027	190031	190035	190039
4	785	190028	190032	190036	190040

BEVEL CHAINS K1000 Pitch 260 mm					
TRACKS	Total Width TL mm	Radius R1=610	Radius R1=650	Radius R1=800	Radius R1=1000
1	270	190041	190045	190049	190053
2	530	190042	190046	190050	190054
3	790	190043	190047	190051	190055
4	1050	190044	190048	190052	190056

Material: Ultra High Molecular Weight Polyethylene to provide minimum friction and reliable long term performance.

Note: max. continuous service temperature in air 90°C. Water absorption coefficient = 0.

Colour: black.

Supply: corner tracks are supplied complete with carry and return plates.

Other Series:

[- 879 - 880 - 881 - 881O Corner Tracks](#)

[- 879 - 880 - 881 - 881O Compact Corner Tracks](#)

CORNER TRACKS for chains series

879 - 880 - 881 - 8810



For steel chains, type:
• 881 • 8810 • 881 VG



For plastic chains, type:
• 879 • 880



Inserts: The corner tracks can be supplied with M8 or M10 brass inserts to your detailed drawing.



Corner tracks Special Dimensions: On request corner tracks with special dimensions can be produced.

More tracks available on request.

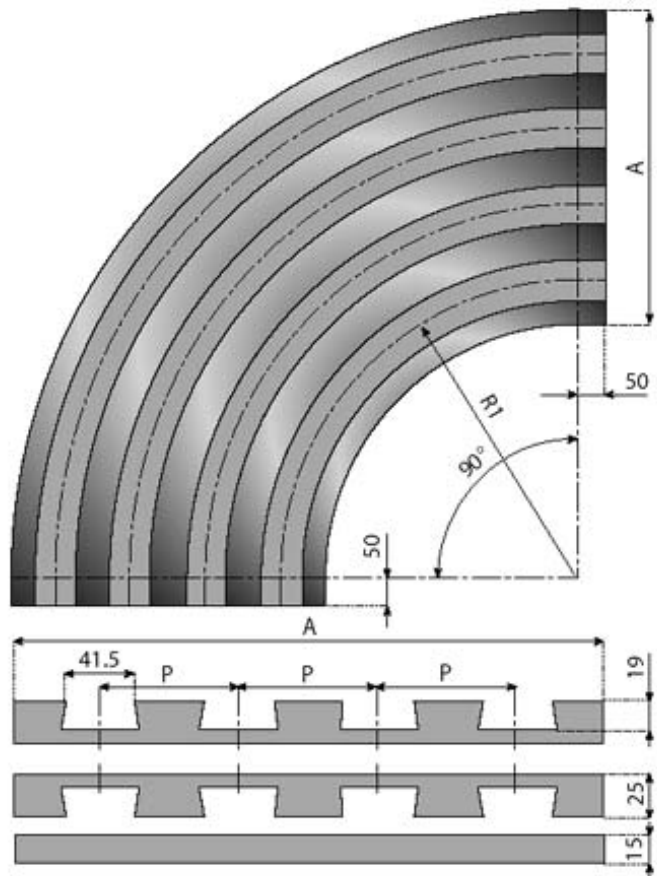
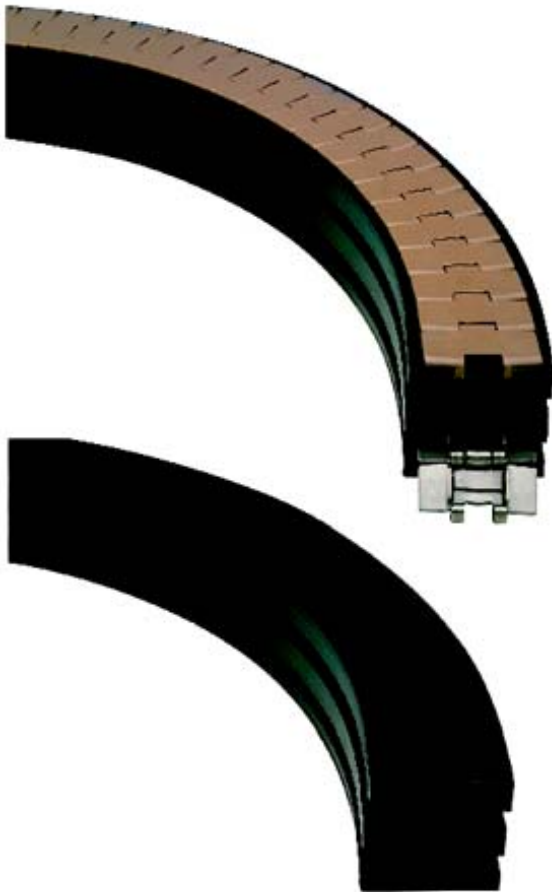

CHAINS K325 Pitch 85 mm

TRACKS	Total Width TL mm	Radius R1=500	Radius R1=610	Radius R1=650	Radius R1=800	Radius R1=1000
1	100	19015	19279	19285	19291	19297
2	185	19303	19308	19313	19318	19323
3	270	19304	19309	19314	19319	19324
4	355	19305	19310	19315	19320	19325
5	440	19306	19311	19316	19321	19326
6	525	19307	19312	19317	19322	19327

CHAINS K325 Pitch 88 mm

TRACKS	Total Width TL mm	Radius R1=500	Radius R1=610	Radius R1=650	Radius R1=800	Radius R1=1000
1	100	19015	19279	19285	19291	19297
2	188	19274	19280	19286	19292	19298
3	276	19275	19281	19287	19293	19299
4	364	19276	19282	19288	19294	19300
5	452	19277	19283	19289	19295	19301
6	540	19278	19284	19290	19296	19302

CHAINS K325 - K350 Pitch 90 mm

TRACKS	Total Width TL mm	Radius R1=500	Radius R1=610	Radius R1=650	Radius R1=800	Radius R1=1000
1	100	19015	19279	19285	19291	19297
2	190	19914	19919	19924	19929	19934
3	280	19915	19920	19925	19930	19935
4	370	19916	19921	19926	19931	19936
5	460	19917	19922	19927	19932	19937
6	550	19918	19923	19928	19933	19938

CHAINS K450 Pitch 120 mm

TRACKS	Total Width TL mm	Radius R1=500	Radius R1=610	Radius R1=650	Radius R1=800	Radius R1=1000
1	130	-	19016	19330	19332	19334
2	250	-	19329	19331	19333	19335
3	370	-	19896	19897	19898	19899
4	490	-	19901	19904	19907	19910
5	610	-	19902	19905	19908	19911
6	730	-	19903	19906	19909	19912

CHAINS K750 Pitch 195 mm						
TRACKS	Total Width TL mm	Radius R1=500	Radius R1=610	Radius R1=650	Radius R1=800	Radius R1=1000
1	200	-	19336	19338	19340	19342
2	395	-	19337	19339	19341	19343
3	590	-	19939	19941	19943	19945
4	785	-	19940	19942	19944	19946

Material: Ultra High Molecular Weight Polyethylene to provide minimum friction and reliable long term performance.

Note: max. continuous service temperature in air 90°C. Water absorption coefficient = 0.

Colour: black.

Supply: corner tracks are supplied complete with carry and return plates.

Other Series:

[- 879 - 880 - 881 - 881O Compact Corner Tracks](#)

[- 882 BEVEL](#)

CORNER TRACKS for chains series

HMGK 50 TAB P1 - HMGK 50 TAB P2

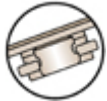

For plastic chains, type:
• HMGK 50 TAB P1 • HMGK 50 TAB P2



Inserts: The corner tracks can be supplied with M8 or M10 brass inserts to your detailed drawing.



Corner tracks Special Dimensions: On request corner tracks with special dimensions can be produced.

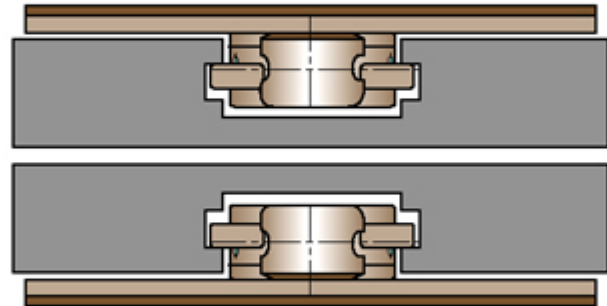
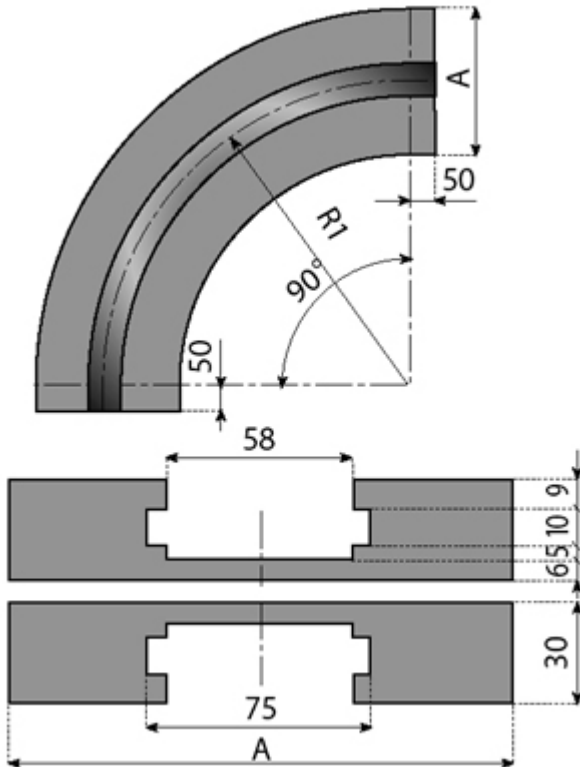

FOR CHAINS WIDTH	CODE	A	R1
HMGK 50 TAB P1	19117	200	550
HMGK 50 TAB P2	19118	270	

Material: Ultra High Molecular Weight Polyethylene to provide minimum friction and reliable long term performance.

Note: max. continuous service temperature in air 90°C. Water absorption coefficient = 0.

Colour: black.

Supply: corner tracks are supplied complete with carry and return plates.

CORNER TRACKS for chains series

878 TAB - 879 TAB - 880 TAB - 881 R TAB - 881 TAB - 881O TAB



For steel chains, type:
• 881 TAB • 881O TAB • 881 TAB VG



For plastic chains, type:
• 878 TAB • 879 TAB • 880 TAB • 878 TAB VG • 879 TAB VG



Inserts: The corner tracks can be supplied with M8 or M10 brass inserts to your detailed drawing.



Corner tracks Special Dimensions: On request corner tracks with special dimensions can be produced.

More tracks available on request.

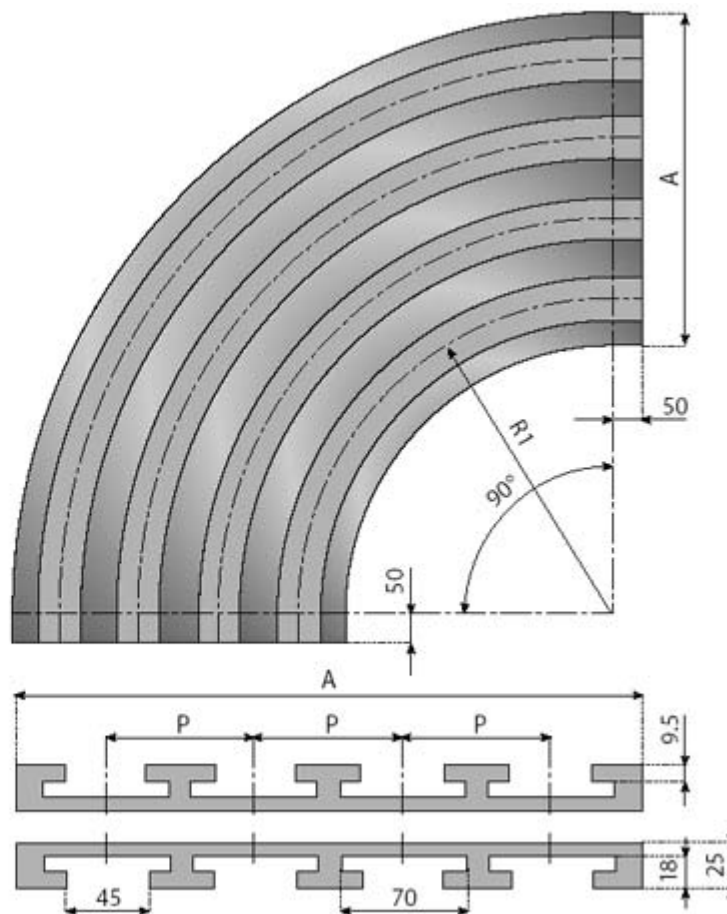

TAB CHAINS K325 Pitch 85 mm						
TRACKS	Total Width TL mm	Radius R1=500	Radius R1=610	Radius R1=650	Radius R1=800	Radius R1=1000
1	100	19017	19125	19131	19137	19143
2	185	19149	19154	19159	19164	19169
3	270	19150	19155	19160	19165	19170
4	355	19151	19156	19161	19166	19171
5	440	19152	19157	19162	19167	19172
6	525	19153	19158	19163	19168	19173

TAB CHAINS K325 Pitch 88 mm						
TRACKS	Total Width TL mm	Radius R1=500	Radius R1=610	Radius R1=650	Radius R1=800	Radius R1=1000
1	100	19017	19125	19131	19137	19143
2	188	19120	19126	19132	19138	19144
3	276	19121	19127	19133	19139	19145
4	364	19122	19128	19134	19140	19146
5	452	19123	19129	19135	19141	19147
6	540	19124	19130	19136	19142	19148

TAB CHAINS K325 - K350 Pitch 90 mm						
TRACKS	Total Width TL mm	Radius R1=500	Radius R1=610	Radius R1=650	Radius R1=800	Radius R1=1000
1	100	19017	19125	19131	19137	19143
2	190	19465	19470	19475	19480	19485
3	280	19466	19471	19476	19481	19486
4	370	19467	19472	19477	19482	19487
5	460	19468	19473	19478	19483	19488
6	550	19469	19474	19479	19484	19489

TAB CHAINS K450 Pitch 120 mm						
TRACKS	Total Width TL mm	Radius R1=500	Radius R1=610	Radius R1=650	Radius R1=800	Radius R1=1000
1	130	-	19018	19175	19177	19179
2	250	-	19174	19176	19178	19180
3	370	-	19445	19449	19453	19457
4	490	-	19446	19450T	19454	19458
5	610	-	19447	19451T	19455	19459
6	730	-	19448	19452T	19456	19460T

TAB CHAINS K750 Pitch 195 mm						
TRACKS	Total Width TL mm	Radius R1=500	Radius R1=610	Radius R1=650	Radius R1=800	Radius R1=1000
1	200	-	19181	19183	19185	19187
2	395	-	19182	19184	19186	19188
3	590	-	19490	19492	19494	19496
4	785	-	19491	19493	19495	19497

Material: Ultra High Molecular Weight Polyethylene to provide minimum friction and reliable long term performance.

Note: max. continuous service temperature in air 90°C. Water absorption coefficient = 0.

Colour: black.

Supply: corner tracks are supplied complete with carry and return plates.

COMPACT CORNER TRACKS for chains series

878 TAB - 879 TAB - 880 TAB - 881 R TAB - 881 TAB - 881O TAB



For steel chains, type:
 • 881 R TAB • 881 TAB • 881O TAB • 881 TAB VG



For plastic chains, type:
 • 878 TAB • 879 TAB • 880 TAB • 878 TAB VG • 879 TAB VG



Inserts: The corner tracks can be supplied with M8 or M10 brass inserts to your detailed drawing.



Corner tracks Special Dimensions: On request corner tracks with special dimensions can be produced.

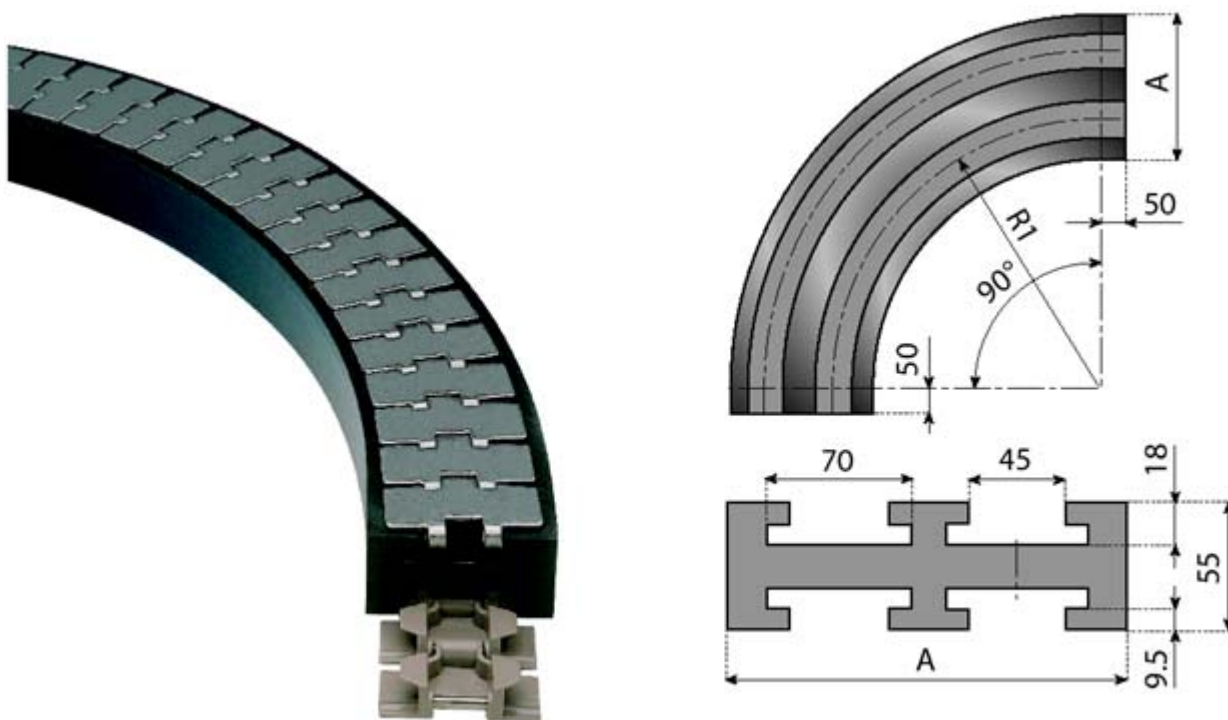

FOR CHAINS WIDTH	CODE	A	R1	PITCH
K325	19106	100	500	90
	19107	190		
K450	19108	130	610	120
	19109	250		

Material: Ultra High Molecular Weight Polyethylene to provide minimum friction and reliable long term performance.

Note: max. continuous service temperature in air 90°C. Water absorption coefficient = 0.

Colour: black.

Supply: 1 piece.

CORNER TRACKS for chains series

882 TAB - LBP 882 TAB - 882 TAB VG



For plastic chains, type:
• 882 TAB • LBP 882 TAB • 882 TAB VG



Inserts: The corner tracks can be supplied with M8 or M10 brass inserts to your detailed drawing.



Corner tracks Special Dimensions: On request corner tracks with special dimensions can be produced.

More tracks available on request.

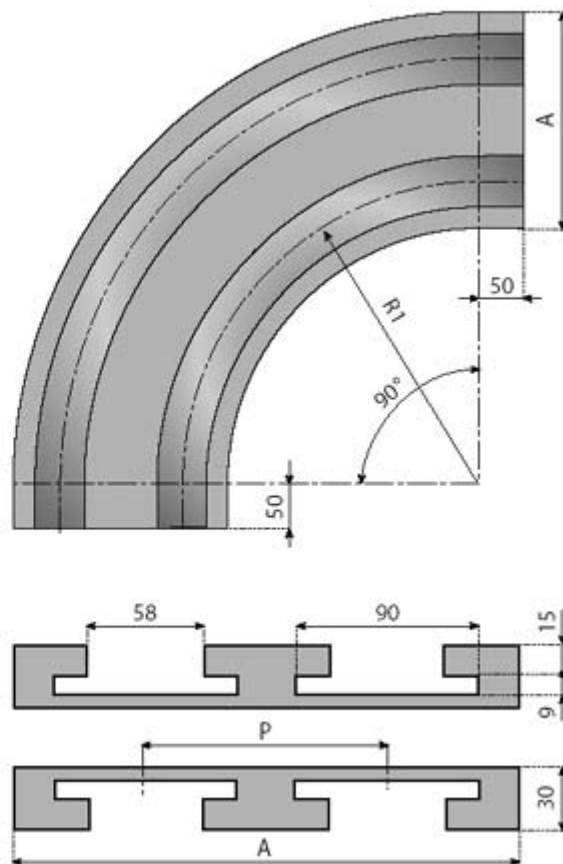

TAB CHAINS K450 Pitch 120 mm					
TRACKS	Total Width TL mm	Radius R1=610	Radius R1=650	Radius R1=800	Radius R1=1000
1	130	19102	19190	19192	19194
2	250	19189	19191	19193	19195
3	370	19950	19954	19958	19962
4	490	19951	19955	19959	19963
5	610	19952	19956	19960	19964
6	730	19953	19957	19961	19965

TAB CHAINS K750 Pitch 195 mm					
TRACKS	Total Width TL mm	Radius R1=610	Radius R1=650	Radius R1=800	Radius R1=1000
1	200	19103	19197	19199	19201
2	395	19196	19198	19200	19202
3	590	19966	19968	19970	19972
4	785	19967	19969	19971	19973

TAB CHAINS K1000 Pitch 260 mm					
TRACKS	Total Width TL mm	Radius R1=610	Radius R1=650	Radius R1=800	Radius R1=1000
1	270	19104	19204	19206	19208
2	530	19203	19205	19207	19209
3	790	19974	19976	19978	19980
4	1050	19975	19977	19979	19981

TAB CHAINS K1200 Pitch 310 mm					
TRACKS	Total Width TL mm	Radius R1=610	Radius R1=650	Radius R1=800	Radius R1=1000
1	320	19105	19211	19213	19215
2	630	19210	19212	19214	19216
3	940	19982	19984	19986	19988
4	1250	19983	19985	19987	19989

Material: Ultra High Molecular Weight Polyethylene to provide minimum friction and reliable long term performance.

Note: max. continuous service temperature in air 90°C. Water absorption coefficient = 0.

Colour: black.

Supply: corner tracks are supplied complete with carry and return plates.

CORNER TRACKS for chains series

1863 - 1873 - 1874



For steel chains, type:
• 1874 • 1874 GS



For plastic chains, type:
• 1863 • 1873 • 1873 VG • 1873 GS



Inserts: The corner tracks can be supplied with M8 or M10 brass inserts to your detailed drawing.



Corner tracks Special Dimensions: On request corner tracks with special dimensions can be produced.

More tracks available on request.

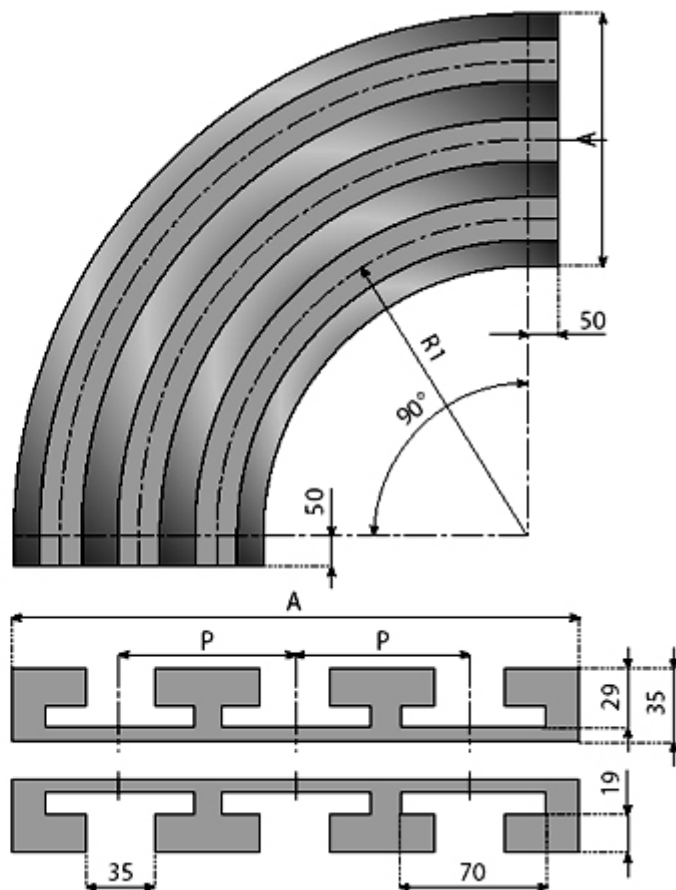

CHAINS K225 Pitch 70 mm						
TRACKS	Total Width TL mm	Radius R1=380	Radius R1=500	Radius R1=610	Radius R1=800	Radius R1=1000
1	75	190060	190064	190068	190072	190076
2	145	190061	190065	190069	190073	190077
3	215	190062	190066	190070	190074	190078
4	285	190063	190067	190071	190075	190079

CHAINS K325 Pitch 85 mm						
TRACKS	Total Width TL mm	Radius R1=380	Radius R1=500	Radius R1=610	Radius R1=800	Radius R1=1000
1	100	190080	19217	19221	19225	19229
2	185	190081	19218	19222	19226	19230
3	270	190082	19219	19223	19227	19231
4	355	190083	19220	19224	19228	19232

CHAINS K325 Pitch 90 mm						
TRACKS	Total Width TL mm	Radius R1=500	Radius R1=610	Radius R1=650	Radius R1=800	Radius R1=1000
1	100	19217	19221	190092	19225	19229
2	190	190085	190089	190093	190097	190101
3	280	190086	190090	190094	190098	190102
4	370	190087	190091	190095	190099	190103

CHAINS K450 Pitch 120 mm						
TRACKS	Total Width TL mm	Radius R1=380	Radius R1=500	Radius R1=610	Radius R1=800	Radius R1=1000
1	130	190104	19233	19235	19237	19239
2	250	190105	19234	19236	19238	19240
3	370	190106	190108	190110	190112	190114
4	490	190107	190109	190111	190113	190115

CHAINS K600 Pitch 160 mm						
TRACKS	Total Width TL mm	Radius R1=500	Radius R1=610	Radius R1=650	Radius R1=800	Radius R1=1000
1	170	19241	19243	190116	19245	19247
2	330	19242	19244	190117	19246	19248
3	490	190118	190120	190122	190124	190126
4	650	190119	190121	190123	190125	190127

CHAINS K750 Pitch 195 mm						
TRACKS	Total Width TL mm	Radius R1=500	Radius R1=610	Radius R1=650	Radius R1=800	Radius R1=1000
1	200	19249	19251	190128	19253	19255
2	395	19250	19252	190129	19254	19256
3	590	190130	190132	190134	190136	190138
4	785	190131	190133	190135	190137	190139

CHAINS K1000 Pitch 260 mm						
TRACKS	Total Width TL mm	Radius R1=500	Radius R1=610	Radius R1=650	Radius R1=800	Radius R1=1000
1	270	19257	19259	190140	19261	19263
2	530	19258	19260	190141	19262	19264

CHAINS K1200 Pitch 310 mm						
TRACKS	Total Width TL mm	Radius R1=500	Radius R1=610	Radius R1=650	Radius R1=800	Radius R1=1000
1	320	19267	19265	190142	19269	19271
2	630	19268	19266	190143	19270	19272

Material: Ultra High Molecular Weight Polyethylene to provide minimum friction and reliable long term performance.

Note: max. continuous service temperature in air 90°C. Water absorption coefficient = 0.

Colour: black.

Supply: corner tracks are supplied complete with carry and return plates.

CORNER TRACKS for chains series

1843



For plastic chains, type:
• 1843



Inserts: The corner tracks can be supplied with M8 or M10 brass inserts to your detailed drawing.



Corner tracks Special Dimensions: On request corner tracks with special dimensions can be produced.

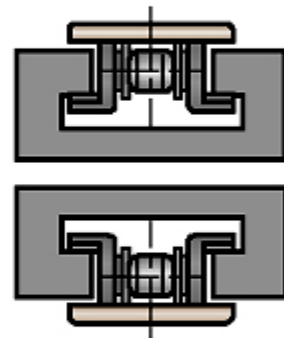
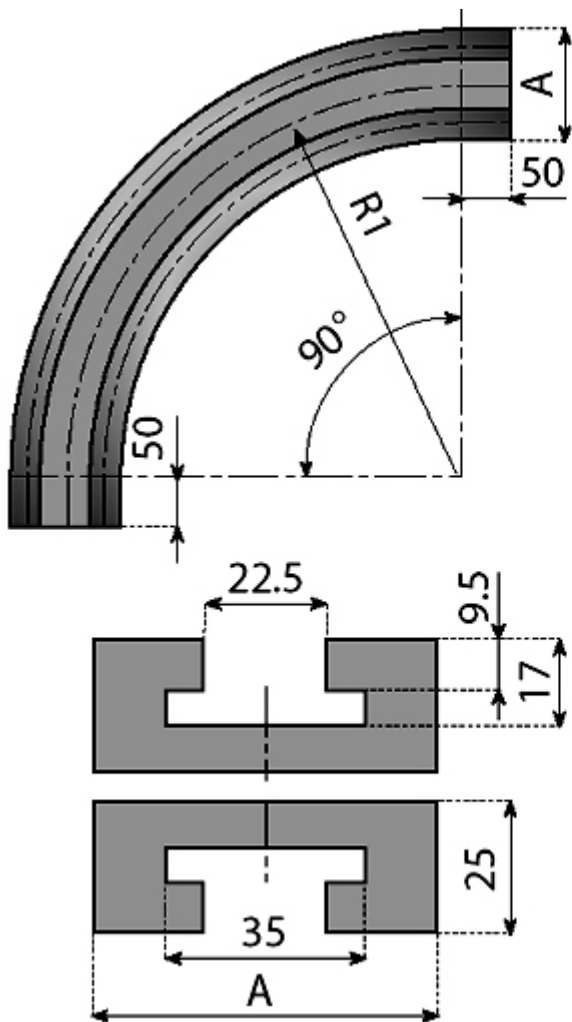

FOR CHAINS WIDTH	CODE	A	R1
K125	19396	50	300
	19397		500
K200	19396L	70	300
	19397L		500

Material: Ultra High Molecular Weight Polyethylene to provide minimum friction and reliable long term performance.

Note: max. continuous service temperature in air 90°C. Water absorption coefficient = 0.

Colour: black.

Supply: corner tracks are supplied complete with carry and return plates.

CORNER TRACKS for chains series

LBP 882 K375



For plastic chains, type:
• LBP 882 K375



Inserts: The corner tracks can be supplied with M8 or M10 brass inserts to your detailed drawing.



Corner tracks Special Dimensions: On request corner tracks with special dimensions can be produced.

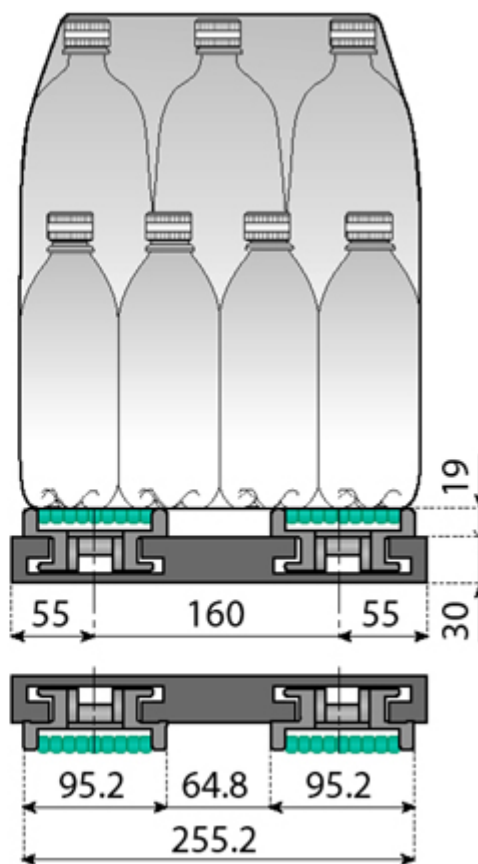
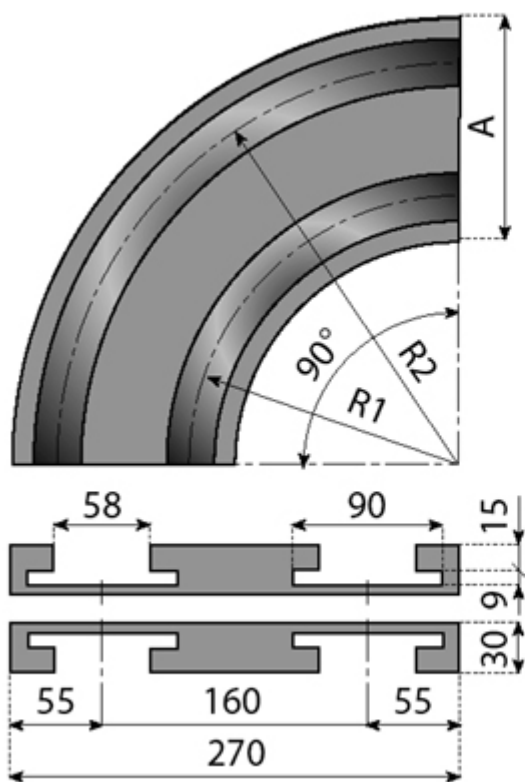

FOR CHAINS WIDTH	CODE	A	TRACKS	R1	R2
K375	19101	270	2	700	860

Material: Ultra High Molecular Weight Polyethylene to provide minimum friction and reliable long term performance.

Note: max. continuous service temperature in air 90°C. Water absorption coefficient = 0.

Colour: black.

Supply: corner tracks are supplied complete with carry and return plates.

CORNER TRACKS for chains series

1883



For plastic chains, type:
• 1883



Inserts: The corner tracks can be supplied with M8 or M10 brass inserts to your detailed drawing.



Corner tracks Special Dimensions: On request corner tracks with special dimensions can be produced.

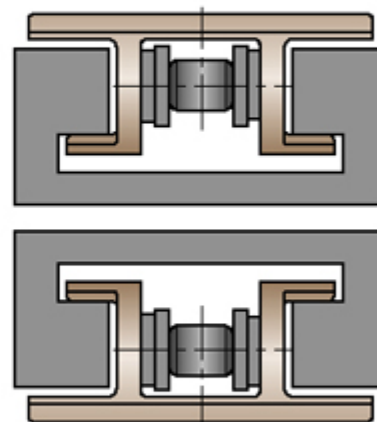
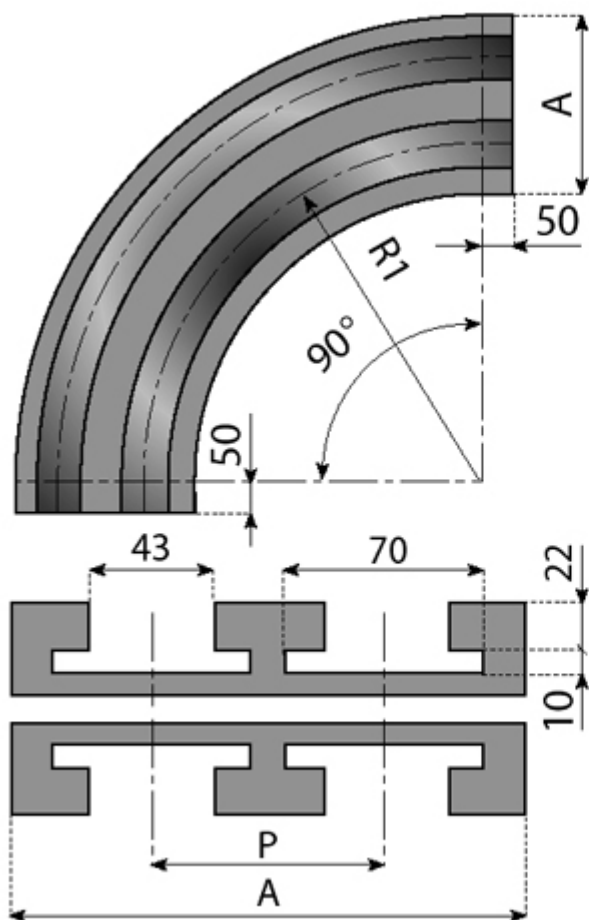

FOR CHAINS WIDTH	CODE	A	R1	PITCH
K325	19110	100	750	90
	19111	190		

Material: Ultra High Molecular Weight Polyethylene to provide minimum friction and reliable long term performance.

Note: max. continuous service temperature in air 90°C. Water absorption coefficient = 0.

Colour: black.

Supply: corner tracks are supplied complete with carry and return plates.

CORNER TRACKS for cardanic chains series

1701 TAB - 1701 TAB OP - 7000 TAB - 7001 TAB - 7005 TAB



For plastic chains, type:
 • 1701 TAB • 1701 TAB OP • 7000 TAB • 7001 TAB • 7005 TAB



Inserts: The corner tracks can be supplied with M8 or M10 brass inserts to your detailed drawing.



Corner tracks Special Dimensions: On request corner tracks with special dimensions can be produced.

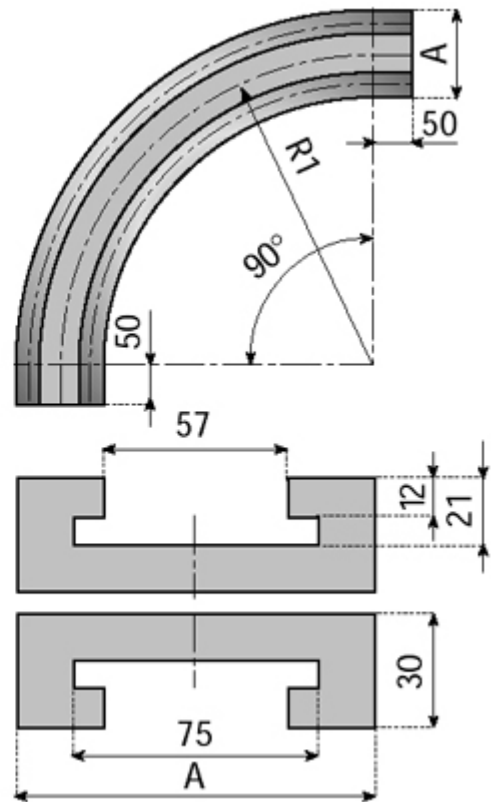

FOR CHAINS WIDTH	CODE	A	R1
K 55	19390	100	250
	19391		500

Material: Ultra High Molecular Weight Polyethylene to provide minimum friction and reliable long term performance.

Note: max. continuous service temperature in air 90°C. Water absorption coefficient = 0.

Colour: black.

Supply: corner tracks are supplied complete with carry and return plates.

CORNER TRACKS for cardanic chains series

1700 - 1702 (M) - HMGK (FN-MS-P-M) 7000 - 7001 - 7005



For plastic chains, type:
 • 1700 • 1702 (M) • HMGK (FN- MS-P-M) 7000 • 7001 • 7005



Inserts: The corner tracks can be supplied with M8 or M10 brass inserts to your detailed drawing.



Corner tracks Special Dimensions: On request corner tracks with special dimensions can be produced.

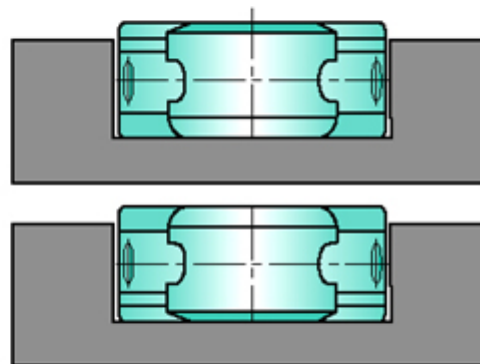
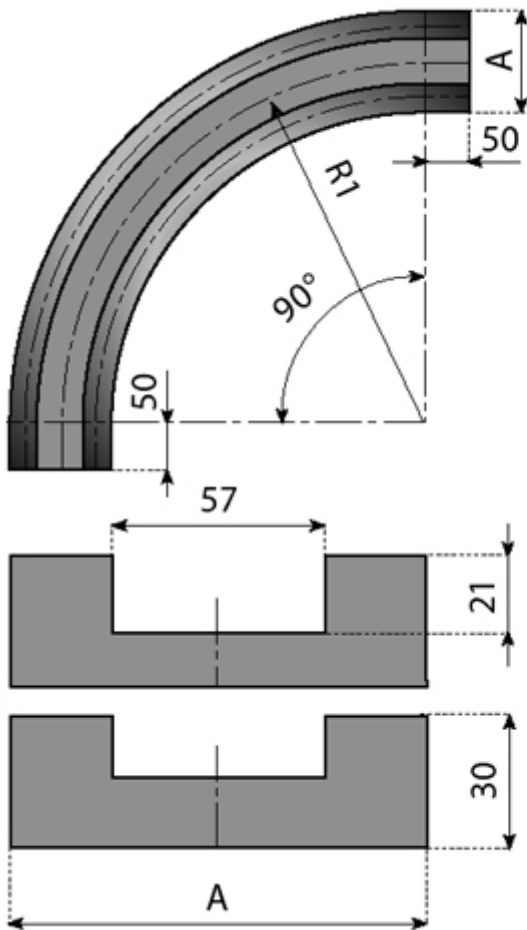

FOR CHAINS WIDTH	CODE	A	R1
K 55	19113	100	250
	19114		500

Material: Ultra High Molecular Weight Polyethylene to provide minimum friction and reliable long term performance.

Note: max. continuous service temperature in air 90°C. Water absorption coefficient = 0.

Colour: black.

Supply: corner tracks are supplied complete with carry and return plates.

CORNER TRACKS for chains series

HMGK 50 TAB M1 - HMGK 50 TAB M2 - HMGK 50 TAB M3



For plastic chains, type:
 • HMGK 50 TAB M1 • HMGK 50 TAB M2 • HMGK 50 TAB M3



Inserts: The corner tracks can be supplied with M8 or M10 brass inserts to your detailed drawing.



Corner tracks Special Dimensions: On request corner tracks with special dimensions can be produced.

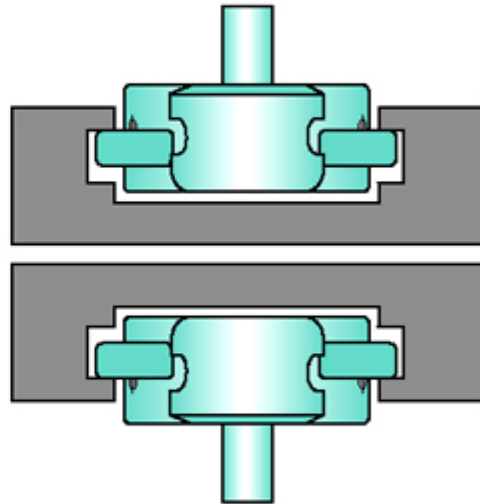
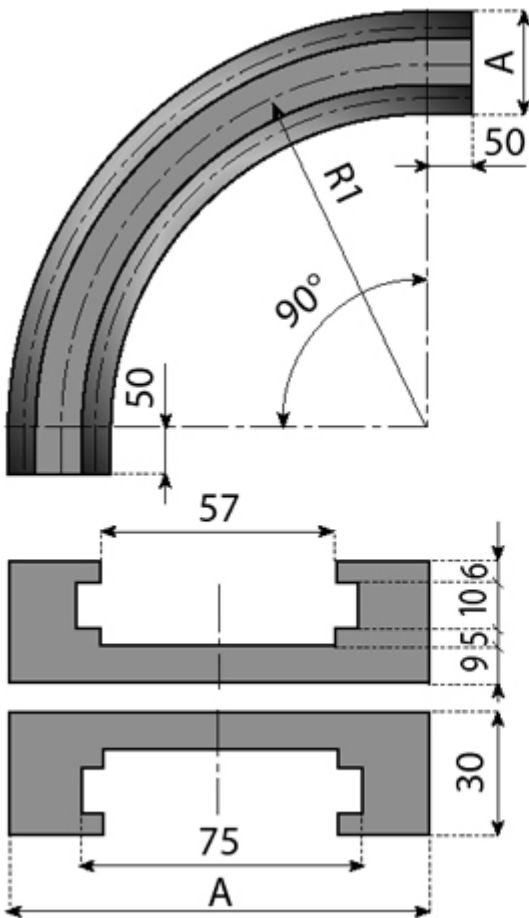

FOR CHAINS WIDTH	CODE	A	R1
HMGK 50 TAB M1	19112	100	250
HMGK 50 TAB M2			
HMGK 50 TAB M3			

Material: Ultra High Molecular Weight Polyethylene to provide minimum friction and reliable long term performance.

Note: max. continuous service temperature in air 90°C. Water absorption coefficient = 0.

Colour: black.

Supply: corner tracks are supplied complete with carry and return plates.

CORNER TRACKS for chains series

HMGK 50 TAB H1 - HMGK 50 TAB H2



For plastic chains, type:
• HMGK 50 TAB H1 • HMGK 50 TAB H2



Inserts: The corner tracks can be supplied with M8 or M10 brass inserts to your detailed drawing.



Corner tracks Special Dimensions: On request corner tracks with special dimensions can be produced.

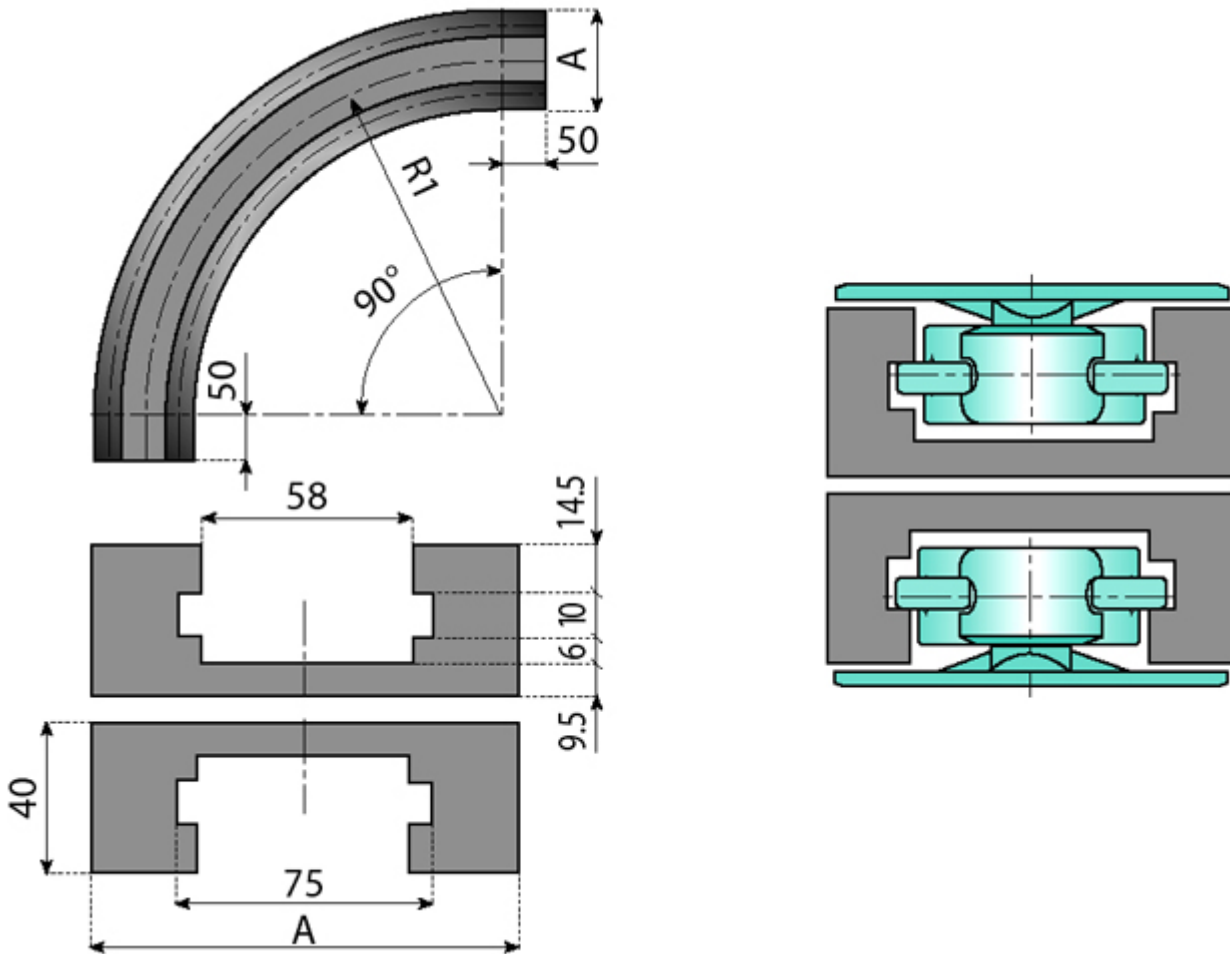

FOR CHAINS WIDTH	CODE	A	R1
HMGK 50 TAB H1	19115	110	250
HMGK 50 TAB H2	19116	200	500

Material: Ultra High Molecular Weight Polyethylene to provide minimum friction and reliable long term performance.

Note: max. continuous service temperature in air 90°C. Water absorption coefficient = 0.

Colour: black.

Supply: corner tracks are supplied complete with carry and return plates.

SELECTION TABLES

Magnetic Curve for sideflexing chains with hinge L = 42.1 mm

Print background colors and images

1.Select "Internet Options" from "Tools" 2.Select "Advancend" in "Internet Option" 3.Enable "Print background colors and images", in printing selection, then press ok 4.Select "Print" in "File" menu.

For chains series	Radius R (mm)	Pitch P (mm)	Basic Width L (mm)	Total Width TL (mm)	Infeed Length IL (mm)	Top Track Height H (mm)	Total Height TH (mm)	Version Series K	Reference Number	
For chains with Lg 82.5 mm - K325" and Lg 83.8 mm - K330 Plate Width - Hinge L. 42.1 mm										
879M - K325 879MVG - K325 880M - K325 881MO - K325 881MO - K330	500	85	100	(PxN°of tracks-1) + L	0	27	82-90	K7	KMD.03__A	
			110		100		90	K6	KMD.03__B	
			111					K10	KMD.61__B	
		89	125		K4			KMD.05__B		
		90	100		K1		KMD.01__C			
		590	180		100		0	82	K2	KMD.02__B
	110						K3		KMD.04__A	
	750	85	111		100		100	82-90	K5B	KMD.06__B
									K5A	KMD.07__B
									K8	KMD.08__B
	860	-	100		110		125	90	K42	KMD.11__B
									K9	KMD.62__B
	1000	85	111		100		0	82	K5C	KMD.09__C
									K5D	KMD.10__A
							100	90	K43	KMD.12__B

For chains series	Radius R (mm)	Pitch P (mm)	Basic Width L (mm)	Total Width TL (mm)	Infeed Length IL (mm)	Top Track Height H (mm)	Total Height TH (mm)	Version Series K	Reference Number
For chains with Lg 114.3 - K450" Plate Width - Hinge L. 42.1 mm									
879M - K450 880M - K450 881M - K450	500	120	129	(PxN°of tracks-1) + L	125	27	90	K21A	KMD.21__C
		610			117			0	K22A
	K27							KMD.23__A	

For chains series	Radius R (mm)	Pitch P (mm)	Basic Width L (mm)	Total Width TL (mm)	Infeed Length IL (mm)	Top Track Height H (mm)	Total Height TH (mm)	Version Series K	Reference Number
For chains with Lg 190.5 - K750" Plate Width - Hinge L. 42.1 mm									
880M - K750 881M - K750	500	192	214	(PxN°of tracks-1) + L	0	27	90	K60	KMD.28__A
	610	196			125			K61	KMD.31__C
	750	-			0			K62	KMD.37__A
	860							K66	KMD.32__A
	890	82			K63		KMD.35__A		
	1000				K65		KMD.33__A		
	1230				K64		KMD.36__A		



Inserts: The magnetic corner tracks can be supplied with M8 or M10 brass inserts to your detailed drawing



Magnetic corner tracks Special Materials: On request magnetic corner tracks for high speed and extremely abrasive applications can be supplied.



Magnetic corner tracks Special Dimensions: On request magnetic corner tracks with special dimensions can be produced.



For further information contact our: Engineering Department.

Explanation of curve reference Example ordering information

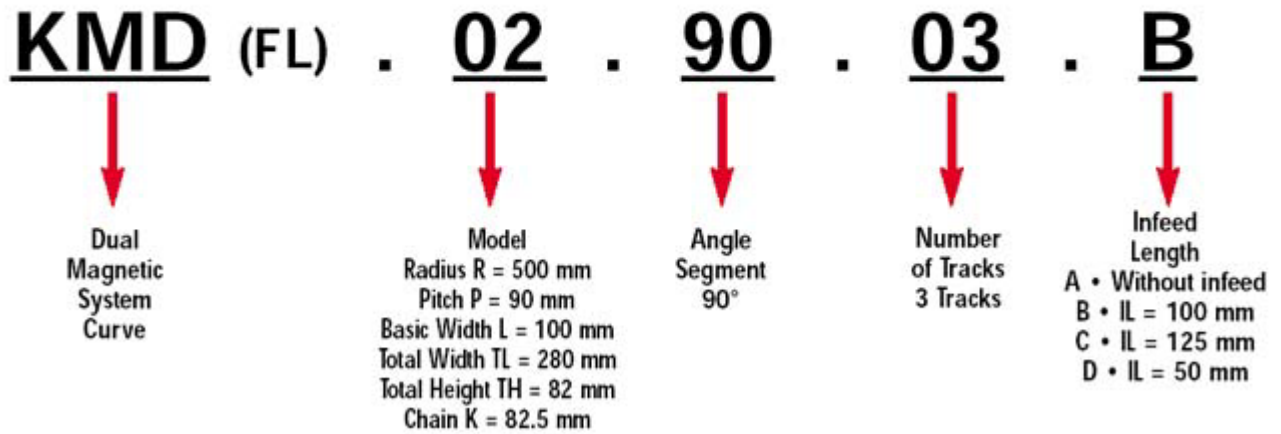



Magnetic Curve
For Sideflexing Chains
with Hinge L = 42.1 mm

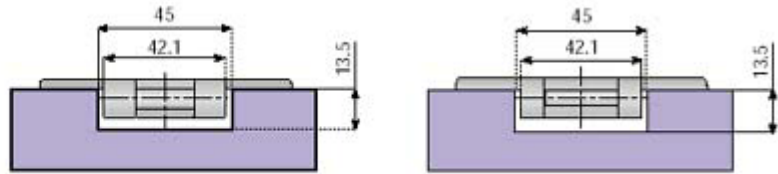

Magnetic Curve
For Sideflexing Chains
with Hinge L = 57 mm

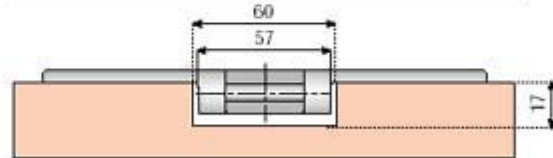
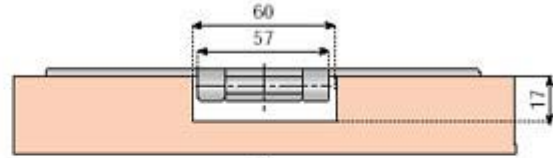

Magnetic Curve
For Sideflexing LBP Chains
with Hinge L = 57 mm

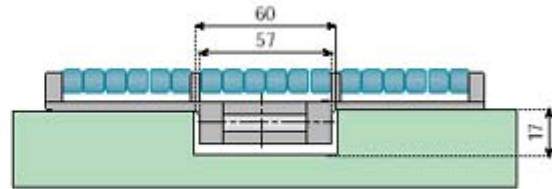

Magnetic Curve
For Sideflexing Chainbelts
with Hinge L = 42.1
H = 8.7 or H = 12.7

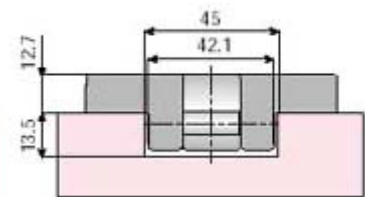
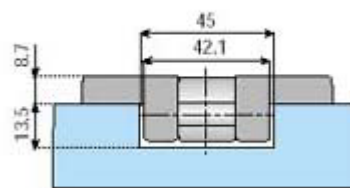

SELECTION TABLES

Magnetic Curve for sideflexing chainbelts with hinge L = 42.1 - H = 12.7

Print background colors and images

1.Select "Internet Options" from "Tools" 2.Select "Advancend" in "Internet Option" 3.Enable "Print background colors and images", in printing selection, then press ok 4.Select "Print" in "File" menu.

For chains series	Radius R (mm)	Pitch P (mm)	Basic Width L (mm)	Total Width TL (mm)	Infeed Length IL (mm)	Top Track Height H (mm)	Total Height TH (mm)	Version Series K	Reference Number
For chainbelts with Lg 83.8 mm - K330" Plate Width - Hinge L.42.1 mm - Plate Height 12.7 mm									
2251M-K330FT 2251M-K330FG	500	85	100	(PxN°of tracks-1) + L	0	27	90	KC7	KMD.84__A
			111		100			KC6	KMD.85__B
			100		0			KC4	KMD.86__B
			111		0			KC8	KMD.87__B
	750		100		0			KC42	KMD.88__B
			111		0			KC43	KMD.89__B
			100		0			KC5D	KMD.97__A
			100		0				



Inserts: The magnetic corner tracks can be supplied with M8 or M10 brass inserts to your detailed drawing



Magnetic corner tracks Special Materials: On request magnetic corner tracks for high speed and extremely abrasive applications can be supplied.



Magnetic corner tracks Special Dimensions: On request magnetic corner tracks with special dimensions can be produced.



Magnetic Curve
For Sideflexing Chains
with Hinge L = 42.1 mm

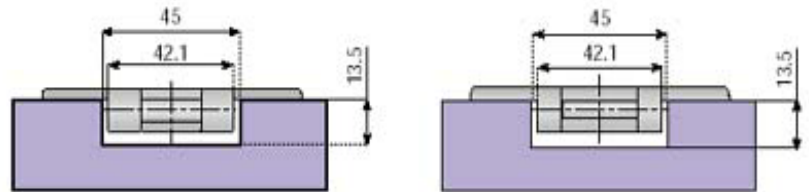

Magnetic Curve
For Sideflexing Chains
with Hinge L = 57 mm

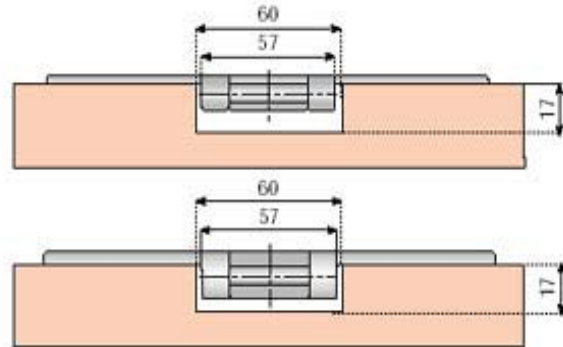

Magnetic Curve
For Sideflexing LBP Chains
with Hinge L = 57 mm

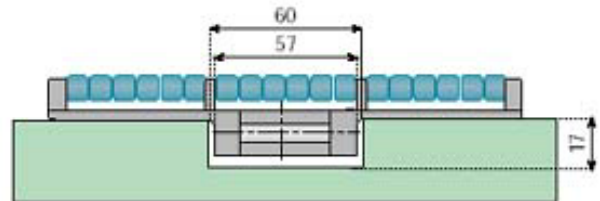

Magnetic Curve
For Sideflexing Chainbelts
with Hinge L = 42.1
H = 8.7 or H = 12.7

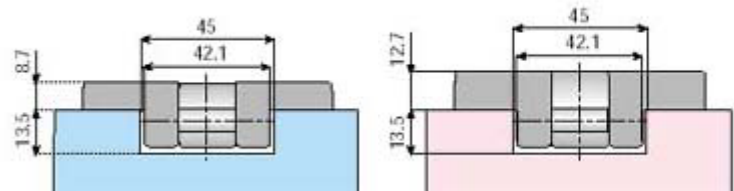

SELECTION TABLES

Magnetic Curve for sideflexing chainbelts with hinge L = 42.1 - H = 8.7

Print background colors and images

1.Select "Internet Options" from "Tools" 2.Select "Advancend" in "Internet Option" 3.Enable "Print background colors and images", in printing selection, then press ok 4.Select "Print" in "File" menu.

For chains series	Radius R (mm)	Pitch P (mm)	Basic Width L (mm)	Total Width TL (mm)	Infeed Length IL (mm)	Top Track Height H (mm)	Total Height TH (mm)	Version Series K	Reference Number
For chainbelts with Lg 83.8 mm - K330" Plate Width - Hinge L. 42.1 mm - Plate Height 8.7 mm									
2250M-K330FT 2250M-K330FG	500	85	100	(PxN°of tracks-1) + L	0	27	82/90	KB7	KMD.90__A
			111		100		KB6	KMD.91__B	
			100		90		KB4	KMD.92__B	
			111		KB8		KMD.93__B		
	750		100		KB42		KMD.94__B		
			111		KB43		KMD.95__B		
			100		KB5D		KMD.96__A		
			100		0				



Inserts: The magnetic corner tracks can be supplied with M8 or M10 brass inserts to your detailed drawing



Magnetic corner tracks Special Materials: On request magnetic corner tracks for high speed and extremely abrasive applications can be supplied.



Magnetic corner tracks Special Dimensions: On request magnetic corner tracks with special dimensions can be produced.

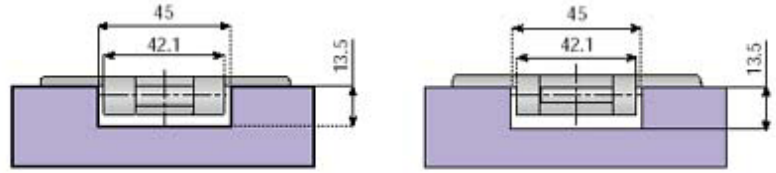

 Magnetic Curve
 For Sideflexing Chains
 with Hinge L = 42.1 mm



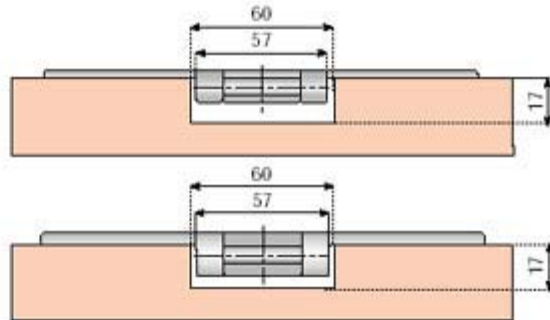

 Magnetic Curve
 For Sideflexing Chains
 with Hinge L = 57 mm

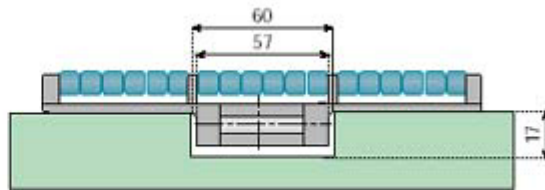

 Magnetic Curve
 For Sideflexing LBP Chains
 with Hinge L = 57 mm

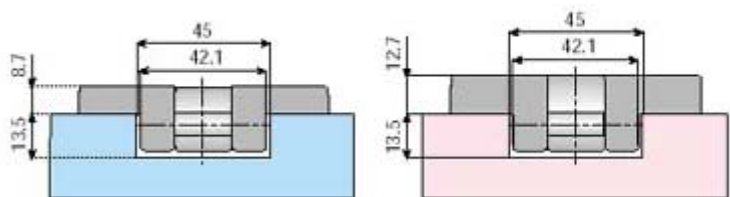

 Magnetic Curve
 For Sideflexing Chainbelts
 with Hinge L = 42.1
 H = 8.7 or H = 12.7



SELECTION TABLES

Magnetic Curve for sidflexing LBP chains with hinge L = 57 mm

Print background colors and images

1. Select "Internet Options" from "Tools" 2. Select "Advancend" in "Internet Option" 3. Enable "Print background colors and images", in printing selection, then press ok 4. Select "Print" in "File" menu.

For chains series	Radius R (mm)	Pitch P (mm)	Basic Width L (mm)	Total Width TL (mm)	Infeed Length IL (mm)	Top Track Height H (mm)	Total Height TH (mm)	Version Series K	Reference Number
For LBP chains with Lg 190.5 mm - K750" Plate Width - Hinge L. 57 mm									
LBP882M-K750	610	195	200	(PxN°of tracks-1) + L	100	32	32+32	LBP81	KMD.70__B
	750							LBP85	KMD.72__B
	860	200	214		0		32+32 or 95	LBP86	KMD.71__A
	1000	195	200		100		32+32	LBP80	KMD.69__B
	1120	-	214		0		32+32 or 95	LBP82	KMD.73__A
	1170							LBP83	KMD.74__A
	1280							LBP84	KMD.75__A

For chains series	Radius R (mm)	Pitch P (mm)	Basic Width L (mm)	Total Width TL (mm)	Infeed Length IL (mm)	Top Track Height H (mm)	Total Height TH (mm)	Version Series K	Reference Number
For LBP chains with Lg 254 mm - K1000" Plate Width - Hinge L. 57 mm									
LBP882M-K1000	610	260	270	(PxN°of tracks-1) + L	0	32	32+32 or 95	LBP91	KMD.76__A
	750	-						LBP92	KMD.77__A
	860							LBP93	KMD.78__A
	1000							LBP94	KMD.79__A

For chains series	Radius R (mm)	Pitch P (mm)	Basic Width L (mm)	Total Width TL (mm)	Infeed Length IL (mm)	Top Track Height H (mm)	Total Height TH (mm)	Version Series K	Reference Number
For LBP chains with Lg 304.8 mm - K1200" Plate Width - Hinge L. 57 mm									
LBP882M-K1200	610	-	320	-	0	32	32+32 or 95	LBP95	KMD.80__A
	750							LBP96	KMD.81__A
	860							LBP97	KMD.82__A
	1000							LBP98	KMD.83__A



Inserts: The magnetic corner tracks can be supplied with M8 or M10 brass inserts to your detailed drawing



Magnetic corner tracks Special Materials: On request magnetic corner tracks for high speed and extremely abrasive applications can be supplied.



Magnetic corner tracks Special Dimensions: On request magnetic corner tracks with special dimensions can be produced.



For further information contact our: Engineering Department

Explanation of curve reference

Example ordering information

KMD (FL) . **02** . **90** . **03** . **B**

↓
Dual
Magnetic
System
Curve

↓
Model
Radius R = 500 mm
Pitch P = 90 mm
Basic Width L = 100 mm
Total Width TL = 280 mm
Total Height TH = 82 mm
Chain K = 82.5 mm

↓
Angle
Segment
90°

↓
Number
of Tracks
3 Tracks

↓
Infeed
Length
A • Without infeed
B • IL = 100 mm
C • IL = 125 mm
D • IL = 50 mm

● Magnetic Curve
For Sideflexing Chains
with Hinge L = 42.1 mm

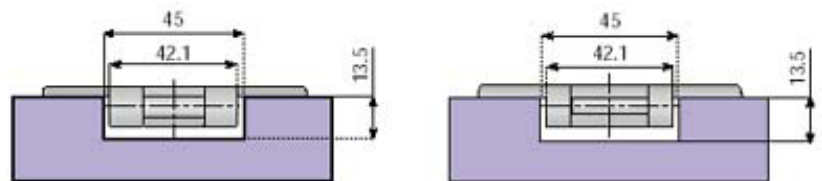

● Magnetic Curve
For Sideflexing Chains
with Hinge L = 57 mm

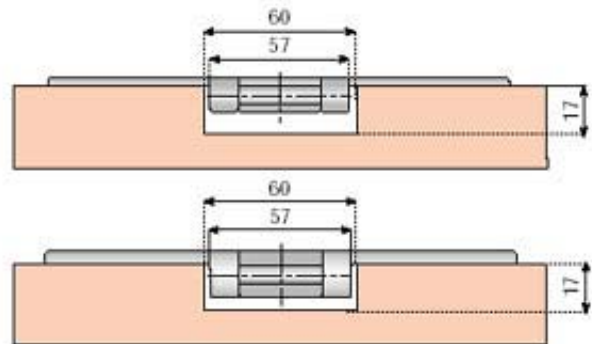

● Magnetic Curve
For Sideflexing LBP Chains
with Hinge L = 57 mm

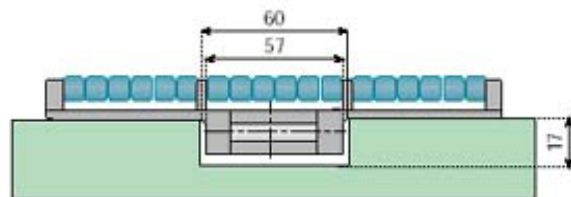

● Magnetic Curve
For Sideflexing Chainbelts
with Hinge L = 42.1
H = 8.7 or H = 12.7

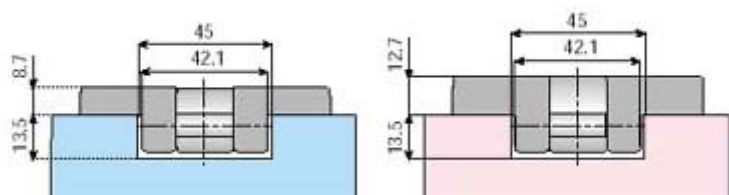

SELECTION TABLES

Magnetic Curve for sideflexing chains with hinge L = 57 mm

Print background colors and images

1.Select "Internet Options" from "Tools" 2.Select "Advancend" in "Internet Option" 3.Enable "Print background colors and images", in printing selection, then press ok 4.Select "Print" in "File" menu.

For chains series	Radius R (mm)	Pitch P (mm)	Basic Width L (mm)	Total Width TL (mm)	Infeed Length IL (mm)	Top Track Height H (mm)	Total Height TH (mm)	Version Series K	Reference Number
For chains with Lg 190.5 mm - K750" Plate Width - Hinge L. 57 mm									
882M - K750 882MVG - K750 8857M - K750	610	195	200	(PxN°of tracks-1) + L	100	32	95	K81*	KMD.40_B
	750							K85	KMD.42_B
	860							K86	KMD.41_A
	1000	195	200		0		87/95	K80	KMD.39_B
	1120	-	214		100		87	K82	KMD.43_A
	1170				K83			KMD.44_A	
	1280				K84			KMD.45_A	

For chains series	Radius R (mm)	Pitch P (mm)	Basic Width L (mm)	Total Width TL (mm)	Infeed Length IL (mm)	Top Track Height H (mm)	Total Height TH (mm)	Version Series K	Reference Number
For chains with Lg 254 mm - K1000" Plate Width - Hinge L. 57 mm									
882M - K1000 882MVG - K1000	610	260	270	(PxN°of tracks-1) + L	0	32	95	K91	KMD.46_A
	750	-						K92	KMD.47_A
	860							K93	KMD.48_A
	1000							K94	KMD.49_A

For chains series	Radius R (mm)	Pitch P (mm)	Basic Width L (mm)	Total Width TL (mm)	Infeed Length IL (mm)	Top Track Height H (mm)	Total Height TH (mm)	Version Series K	Reference Number
For chains with Lg 304.8 - K1200" Plate Width - Hinge L. 57 mm									
882M - K1200 882MVG - K1200	610	-	320	-	0	32	95	K95	KMD.50_A
	750							K96	KMD.51_A
	860							K97	KMD.52_A
	1000							K98	KMD.53_A



Inserts: The magnetic corner tracks can be supplied with M8 or M10 brass inserts to your detailed drawing



Magnetic corner tracks Special Materials: On request magnetic corner tracks for high speed and extremely abrasive applications can be supplied.



Magnetic corner tracks Special Dimensions: On request magnetic corner tracks with special dimensions can be produced.

Explanation of curve reference

Example ordering information

KMD (FL) . **02** . **90** . **03** . **B**

↓
Dual
Magnetic
System
Curve

↓
Model
Radius R = 500 mm
Pitch P = 90 mm
Basic Width L = 100 mm
Total Width TL = 280 mm
Total Height TH = 82 mm
Chain K = 82.5 mm

↓
Angle
Segment
90°

↓
Number
of Tracks
3 Tracks

↓
Infeed
Length
A • Without infeed
B • IL = 100 mm
C • IL = 125 mm
D • IL = 50 mm

● Magnetic Curve
For Sideflexing Chains
with Hinge L = 42.1 mm

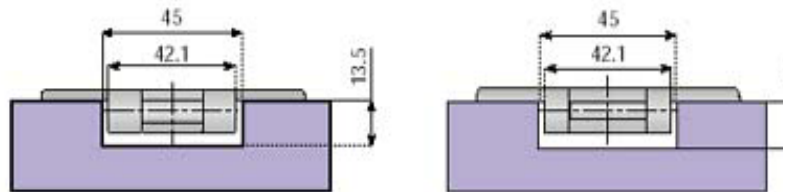

● Magnetic Curve
For Sideflexing Chains
with Hinge L = 57 mm

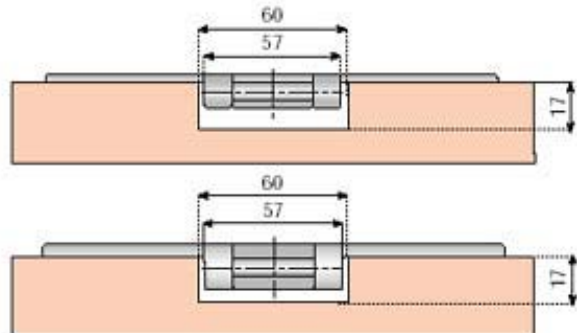

● Magnetic Curve
For Sideflexing LBP Chains
with Hinge L = 57 mm

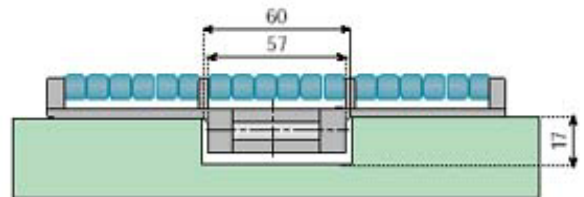

● Magnetic Curve
For Sideflexing Chainbelts
with Hinge L = 42.1
H = 8.7 or H = 12.7

